



# Aerospace Fasteners and Tooling



**Rivets**

**Pneumatic Riveters**

**Cordless Riveters**

**Manual Riveters**

**Kits & Accessories**

**Light String Kits**



# Contents





**Rivets**

9-16



**Pneumatic Riveters**

17-23



**Cordless Riveters**

24-30



**Manual Riveters**

31-37



**Kits & Accessories**

38-58



**Light String Kits**

59-61



# Presentation

## Mission

FSI's unwavering goal to its worldwide customers is to provide the finest, most reliable, state of the art fastening and installation tooling solutions to best equip them in their respective industries. FSI will go to whatever lengths to innovate, engineer and provide quality products that will meet or exceed our customer's expectations, coupled with outstanding service and logistical support. Let FSI's team support your team!

## Company History Experience

Fastening Systems International, Inc. (FSI) is a leading supplier of blind fasteners and blind rivet installation tools for aerospace, military and commercial customers. Headquartered in Sonoma, California, Fastening Systems has been serving the aerospace industry since 1983. The company, while enjoying considerable growth since its founding, still likes to maintain its individual customer relations. We pride ourselves on our ability to respond promptly and efficiently to our customers' needs.

FSI manufactures many of its own rivet installation tool kits. We also distribute quality riveting products manufactured by Avdel USA, Cherry Aerospace Fasteners, Huck/Alcoa Fastening Systems, Gesipa Fasteners USA, Inc., Sioux Power Tools and Zephyr/Lok-fast Tool Company.

In addition to our riveting tool products, FSI is an authorized stocking distributor of blind fasteners for the following companies: Avdel/Infastech, AVK Industrial Products (rivnuts & inserts), Gesipa/Olympic Fastening Systems, Alcoa/Marson/Recoil Fastening Systems and Securit Metal Products (solid rivets).

FSI has a complete tool repair center for Avdel, Cherry (Commercial & Aerospace), Huck (Aerospace, Automotive & Aftermarket) Gesipa & Olympic USA. Call or e-mail us for further information about these products. We offer catalogs for your fastener and riveting tool needs. When you contact FSI get ready for a "Riveting Experience!"

## Pledge of Service

Our aim is to provide outstanding service and quality Aviation/Aerospace and Industrial tools and fasteners at a reasonable price. To this end, we are constantly looking for ways to meet the needs of our customers. We are committed to developing new fastening solutions and bringing them to market faster by utilizing the wealth of experience in our personnel while maximizing output and profitability for our customers.

Your input is very valuable to us and we encourage you to send us your comments. Call (800) 344-2393 or e-mail us at [sales@fsirivet.com](mailto:sales@fsirivet.com) and let us know how we can better serve you.







# Equivalencies

## FSI, Huck, Cherry

FSI	HUCK	CHERRY
 <p>PT-100M-CM **</p>	 <p>2013 + 99-3442</p>	 <p>G704B (or G747) + H701B-456</p>
 <p>PT-100-MIL-5 **</p>	No Equal	 <p>G704BCMR</p>
 <p>PT-202F</p>	 <p>202 + 99-3458-202 + 99-2645</p>	 <p>G84 + H84A-8 + H846-456</p>
 <p>PT-4000H</p>	No Equal	No Equal

\*\* Exceeds pull force and stroke of the G704B, G747 and the 2013 with a slightly slower installation cycle and a shorter MTBF.

FSI	HUCK	CHERRY
 <p>D-700C</p>	<p>No Equal</p>	 <p>G800 + H800-8</p>
 <p>D-700-MIL-4</p>	<p>No Equal</p>	 <p>G800CMR + H800-8</p>
 <p>PT-747</p>	 <p>2013 + H701B-456</p>	 <p>G747 + H701B-456</p>



# Rivets 1



## Contents

Rivet HuckMax®/CherryMax®

Rivet CherryLock®

Rivet CherryMAX® «AB»

Rivet CherryLock® «A»

Rivet Huck-Clinch®

Rivet Cherry Maxibolt™

Rivet POP®

## Rivets HuckMax®/CherryMax®



The HuckMAX® / CherryMax® rivets are the most reliable, high strength structural fasteners with visual inspectability in the world today. They feature the “Safe-lock” locking collar for more reliable joint integrity. HuckMAX® / CherryMax® rivets provide a large bearing surface area on the blind side of the structure, giving dependable results, even when installed in difficult thin sheet stack-up applications.

### CROSS REFERENCE TABLE

NAS Part No	HUCK® Part No	Cherry® Part No	BOEING Part No	AIRBUS Part No
NAS9301B	HR3213	CR3213	-	ASNA0078A
NAS9301E	HR3223	CR3223	-	ASNA0078B
NAS9302B	HR3212	CR3212	-	ASNA0077A
NAS9302E	HR3222	CR3222	-	ASNA0077B
NAS9303B	HR3214	CR3214	-	-
NAS9303E	HR3224	CR3224	-	-
NAS9304B	HR3243	CR3243	BACR15FR()B()R	ASNA0078A()X
NAS9304E	HR3253	CR3253	BACR15FR()E()R	ASNA0078B()X
NAS9305B	HR3242	CR3242	BACR15FP()B()R	ASNA0077A()X
NAS9305E	HR3252	CR3252	BACR15FP()E()R	ASNA0077B()X
NAS9306B	HR3245	CR3245	-	-
NAS9306E	HR3255	CR3255	-	-
NAS9307M	HR3523	CR3523	-	ASNA0078C/E
NAS9307MP	-	CR3523P	-	ASNA0078D/F
NAS9308M	HR3522	CR3522	-	ASNA0077C/E
NAS9308MP	-	CR3522P	-	ASNA0077D/F
NAS9309	HR3524	CR3524	-	-
NAS9309MP	-	CR3524P	-	-
NAS9310M	HR3553	CR3553	BACR15FR()M()R	ASNA0078C/E()X
NAS9310MP	-	CR3553P	BACR15FR()MP()R	ASNA0078D/F()X
NAS9310C	-	CR3853	-	-
NAS9311M	HR3552	CR3552	BACR15FP()M()R	ASNA0077C/E()X
NAS9311MP	-	CR3552P	BACR15FP()MP()R	ASNA0077D/F()X
NAS9311C	-	CR3852	-	-
NAS9312M	HR3555	CR3555	-	-
NAS9312MP	-	CR3555P	-	-





### D-28 Riveter

**Type:** Hand Mechanical Riveter

**Features:** Light-weight manual tool,  
Nosepieces stored in handle

#### Nosepieces

3/32"	1/8"	5/32"	3/16"	1/4"
F156-NP	F159-CH	-	-	-



### D-700C Riveter

**Type:** Manual Hand Hydraulic Riveter

**Features:** Light-weight, Compact, Powerful,  
Pressure adjustable

#### Nosepieces

3/32"	1/8"	5/32"	3/16"	1/4"
F156	F159	F143	F143	F142



### PT-100 Riveter

**Type:** Air-Hydraulic Riveter

**Features:** Powerful, Versatile, Productive

#### Nosepieces

3/32"	1/8"	5/32"	3/16"	1/4"
F156	F159	F143	F143	F142



### PT-4000 Riveter

**Type:** Cordless Riveter

**Features:** Powerful, Versatile, Portable

#### Nosepieces

3/32"	1/8"	5/32"	3/16"	1/4"
F156	F159	F143	F143	F142



# Rivets CherryMax® «AB»

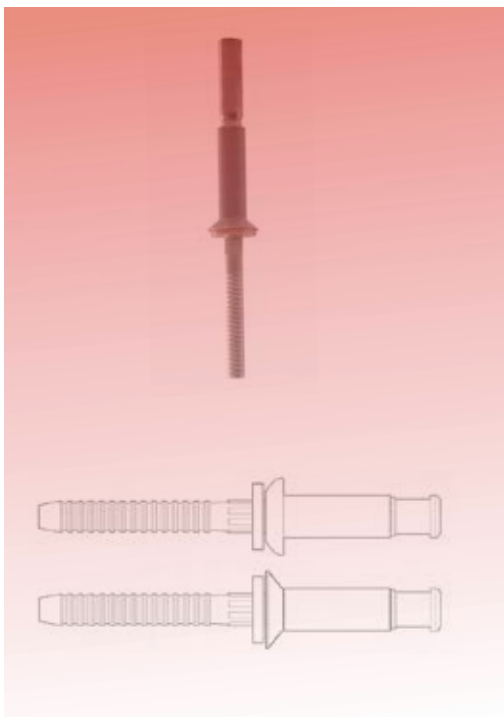

As part of the CHERRYMAX ® family of proven fastening systems, CHERRYMAX ® 'AB' rivets are lock-spindle, flush fracturing, structural rivets exceeding the requirements of procurement specification NAS1400 and NAS1398/1399 standard pages.

## CROSS REFERENCE CHART

NAS Part No	CHERRY® Part No	NAS Part No	CHERRY® Part No
NAS1399D()AB()	CR4172	NAS1398D()AB()	CR4173
NAS1399B()AB()	CR4272	NAS1398B()AB()	CR4273
NAS1399M()AB()	CR4522	NAS1398MW()AB()	CR4523P
NAS1399MW()AB()	CR4522P	NAS1398C()AB()	CR4623
NAS1399C()AB()	CR4622	-	CR4623D
-	CR4622D	NAS1398CW()AB()	CR4623CW
NAS1399CW()AB()	CR4622CW		



### D-28 Riveter

**Type:** Hand Mechanical Riveter

**Features:** Light-weight manual tool, Nosepieces stored in handle

#### Nosepieces

3/32"	1/8"	5/32"	3/16"	1/4"
-	F159-CH	-	-	-



### D-700C Riveter

**Type:** Manual Hand Hydraulic Riveter

**Features:** Light-weight, Compact, Powerful, Pressure adjustable

#### Nosepieces

3/32"	1/8"	5/32"	3/16"	1/4"
-	F159	F143	F143	F142



### PT-100 Riveter

**Type:** Air-Hydraulic Riveter

**Features:** Powerful, Versatile, Productive

#### Nosepieces

3/32"	1/8"	5/32"	3/16"	1/4"
-	F159	F143	F143	F142



### PT-4000 Riveter

**Type:** Cordless Riveter

**Features:** Powerful, Versatile, Portable

#### Nosepieces

3/32"	1/8"	5/32"	3/16"	1/4"
-	F159	F143	F143	F142



**SAFETY:** Read and follow all safety instructions  
**WARNING:** The guards are mandatory

# Rivets CherryLock® «A»

CHERRYLOCK® 'A' Code "non-shift", self-plugging blind rivets provide excellent hole-fill and sheet take-up capability conforming to the Procurement Specification NAS1400 and standards Pages NAS1398/1399.

## CROSS REFERENCE CHART

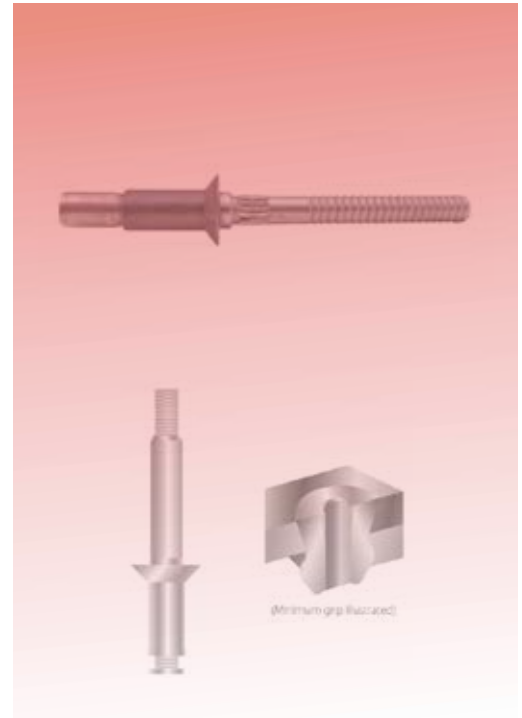

NAS Part No	CHERRY® P/N	NAS Part No	CHERRY® P/N
NAS1399D()A()	CR2172	NAS1398D()A()	CR2173
NAS1399B()A()	CR2272	NAS1398B()A()	CR2273
NAS1399M()A()	CR2572	NAS1398M()A()	CR2573
NAS1399MW()A()	CR2572P	NAS1398MW()A()	CR2573P
NAS1399MS()A()	CR2572S	NAS1398MS()A()	CR2573S
NAS1399C()A()	CR2672	NAS1398C()A()	CR2673
NAS1399CW()A()	CR2672CW	NAS1398CW()A()	CR2673CW
NAS1399CS()A()	CR2672S	NAS1398CS()A()	CR2673S



### D-28 Riveter

**Type:** Hand Mechanical Riveting

**Features:** Light-weight manual tool, Nosepieces stored in handle

### Nosepieces

3/32"	1/8"	5/32"	3/16"	1/4"
F390	F391	F392	-	-



### D-700C Riveter

**Type:** Manual Hand Hydraulic Riveter

**Features:** Light-weight, Compact, Powerful, Pressure adjustable

### Nosepieces

3/32"	1/8"	5/32"	3/16"	1/4"
F390	F391	F392	F393	-



### PT-100 Riveter

**Type:** Air-Hydraulic Riveter

**Features:** Powerful, Versatile, Productive

### Nosepieces

3/32"	1/8"	5/32"	3/16"	1/4"
F390	F391	F392	F393	-



### PT-4000 Riveter

**Type:** Cordless Riveter

**Features:** Powerful, Versatile, Portable

### Nosepieces

3/32"	1/8"	5/32"	3/16"	1/4"
F390	F391	F392	F393	-

# Rivets Huck-Clinch®

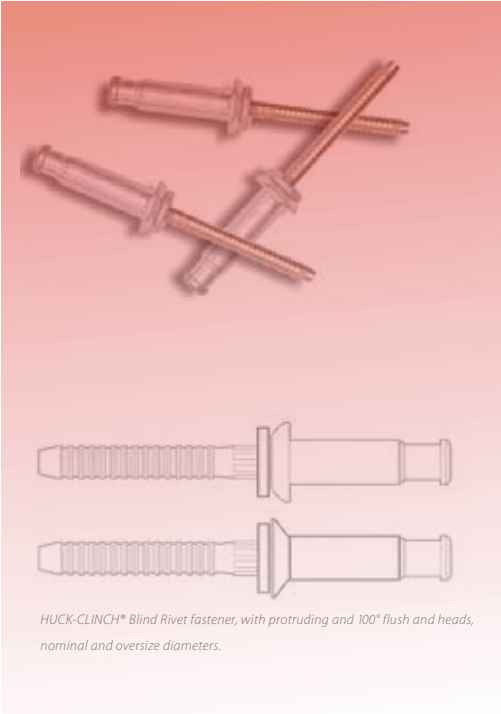

HUCK-CLINCH® Blind Rivet fastener, with protruding and 100° flush and heads, nominal and oversize diameters.

HUCK-CLINCH® blind rivets are precision-made aerospace fasteners produced to the requirements of the MIL-R-7885 and NAS1686 procurement standards. The internal, integral lock makes them ideal fasteners for high-vibration, FOD critical applications. The enhanced hole-fill and sheet take-up capabilities of these fasteners provide superior ultimate and fatigue strength for the most demanding blind rivet applications.

### CROSS REFERENCE CHART

NAS Part No	HUCK® P/N	NAS Part No	HUCK® Part No
NAS9302B	HC3212	-	HC6222
NAS9301B	HC3213	-	HC6223
NAS9303B	HC3214	-	HC6224
NAS9305B	HC3242	-	HC6252
NAS9304B	HC3243	-	HC6253
NAS9306B	HC3245		



### D-28 Riveter

**Type:** Hand Mechanical Riveter  
**Features:** Light-weight manual tool, Nosepieces stored in handle

### Nosepieces

3/32"	1/8"	5/32"	3/16"	1/4"
-	F159-CH	-	-	-



### D-700C Riveter

**Type:** Manual Hand Hydraulic Riveter  
**Features:** Light-weight, Compact, Powerful, Pressure adjustable

### Nosepieces

3/32"	1/8"	5/32"	3/16"	1/4"
-	F159	F143	F143	F142



### PT-100 Riveter

**Type:** Air-Hydraulic Riveter  
**Features:** Powerful, Versatile, Productive

### Nosepieces

3/32"	1/8"	5/32"	3/16"	1/4"
-	F159	F143	F143	F142



### PT-4000 Riveter

**Type:** Cordless Riveter  
**Features:** Powerful, Versatile, Portable

### Nosepieces

3/32"	1/8"	5/32"	3/16"	1/4"
-	F159	F143	F143	F142



**SAFETY:** Read and follow all safety instructions  
**WARNING:** The guards are mandatory



# Rivets Cherry MaxiBolt®

The Cherry MAXIBOLT® Blind Bolt system is available in alloy steel and A-286 CRES materials. It conforms to the MS90353/MS90354 and the MS21140/MS21141, meets the requirements of the MIL-F-81177 and MIL-F-8975. Maxibolts are primarily used in structures where higher loads are required. The steel version is 112 KSI shear and the A286 version is 95 KSI shear.

## CROSS REFERENCE CHART

MS P/N	CHERRY® P/N	BOEING P/N	CHERRY® P/N
MS90353S	CR7310S	-	CR7650S - OS
MS90354S	CR7311S	-	CR7651S- OS
MS21140S	CR7620S	BACB30YY	CR7770S - TITANIUM
MS21141S	CR7621S	BACB30YU	CR7771S - TITANIUM
-	CR7340S	-	CR7773S - TITANIUM
-	CR7341S	BACB30YT	CR7774S- TITANIUM

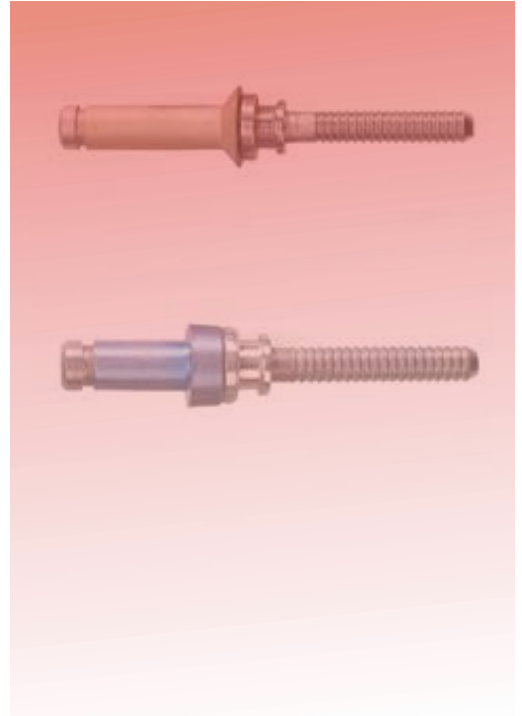

### D-700C Riveter

**Type:** Manual Hand Hydraulic Riveter

**Features:** Light-weight, Compact, Powerful, Pressure adjustable

#### Nosepieces

3/32"	1/8"	5/32"	3/16"	1/4"
-	-	F505U	F506	-



### PT-100 Riveter

**Type:** Air-Hydraulic Riveter

**Features:** Powerful, Versatile, Productive

#### Nosepieces

3/32"	1/8"	5/32"	3/16"	1/4"
-	-	F505U	F506	-



### PT-4000 Riveter

**Type:** Cordless Riveter

**Features:** Powerful, Versatile, Portable

#### Nosepieces

3/32"	1/8"	5/32"	3/16"	1/4"
-	-	F505U	F506	-



# Rivets POP®



The POP® style blind rivets includes a wide range of body styles, materials, and special finishes. POP® rivets are made to the IFI114 specification and are an excellent strong low cost fastening system.

### CROSS REFERENCE CHART

POP® Part No	CHERRY® P/N	POP® Part No	CHERRY® P/N
AD()ABS	AAP-()	AD()ABSLF	AAL-()
AD()BS	BSP-()	AD()SLF	BSL-()
SD()BS	SSP-()	SD()BSLF	SSL-()
SSD()SSBS	CCP-()		



### D-28 Riveter

**Type:** Hand Mechanical Riveter

**Features:** Light-weight manual tool, Nosepieces stored in handle

### Nosepieces

3/32"	1/8"	5/32"	3/16"	1/4"
F156NP	F159-CH	F140	F143-CH	-



### D-700C Riveter

**Type:** Manual Hand Hydraulic Riveter

**Features:** Light-weight, Compact, Powerful, Pressure adjustable

### Nosepieces

3/32"	1/8"	5/32"	3/16"	1/4"
F156	F159	F140	F143	F142



### PT-100 Riveter

**Type:** Air-Hydraulic Riveter

**Features:** Powerful, Versatile, Productive

### Nosepieces

3/32"	1/8"	5/32"	3/16"	1/4"
F156	F159	F140	F143	F142



### PT-4000 Riveter

**Type:** Cordless Riveter

**Features:** Powerful, Versatile, Portable

### Nosepieces

3/32"	1/8"	5/32"	3/16"	1/4"
F156	F159	F140	F143	F142



# Pneumatic Riveters



## Contents

Air-Hydraulic Riveters  
Pneumatic Riveters



## Fastener Installation Procedure

- Insert rivet into the prepared hole
- Place the riveter pulling head over the rivet stem
- Hold the riveter in line with the axis of the rivet
- Actuate the riveter by pulling the trigger, the action of the riveter will automatically align the rivet to the work surface
- The rivet stem will be ejected from the front of the tool



## Selecting the Correct Tool

### Tool Selection:

To ensure proper tool selection, answer the following questions:

- What type of rivets are you installing?
- What is the diameter of the rivet?
- What are your pull force requirements?
- Do you have any restraints?

## Typical Use

The PT-100 series riveters allow the installation of the types of blind rivets commonly used in the aviation industry (Huck ®, Cherry ®, Olympic ®, Avdel ® and Pop ®).

These tools are also capable of installing most commercial straight pull blind rivets up to 1/4" diameter. The FSI cordless riveters are used in many industries such as truck & trailer, automotive, rail and marine.



## PISTOL GRIP STYLE



### Description

Evolving out of the successful D-100 series Hand Hydraulic version, the air operated PT-100 Series Blind Riveter continues the tradition of offering a unique blend of power, versatility and compact size. Almost all straight pull style blind rivets with required installation loads of 4,000 lbs. or less can be installed with the PT-100 series riveter. Although most often used to install CherryMax® and Huck-Clinch® blind rivets, a wide variety of adapters, nosepieces, and special pulling heads are available to insure maximum flexibility for any single action blind rivet requirement. The PT-100 Series Riveter utilizes a patented, air motor driven, multiple valve cylinder hydraulic pump assembly. Unlike most blind riveters, the PT-100 Series Riveter permits stroke control. Upon trigger actuation, the tool's nose assembly moves forward as long as the trigger is depressed or until maximum stroke is reached. The jaw assembly, which holds the rivet stem, remains stationary. Trigger movement allows the user to monitor and control the stroke length of the tool, if required. A releasing trigger is provided to eject the stem from the nose assembly after the rivet is installed.

### Riveter Capabilities

Rivet Types	Rivet Dimensions				
	3/32"	1/8"	5/32"	3/16"	1/4"
CherryMAX®, CherryMAX® 'AB', HuckMax®, Cherry SST®, AVEX®	-	✓	✓	✓	✓
Avdel® MBC, POP® rivets, Cherry® & Olympic® MS	✓	✓	✓	✓	✓
Cherry Interlok®, Huck Magna-Lok®, Cherry MAXIBOLT®, Monobolts, Olympic Bulb-Tite®	-	-	✓	✓	✓
Magna-Bulb®	-	-	-	-	✓

### PT-100 Specifications

Power Source: Air-Hydraulic  
 Air Pressure: 90-120 psi (6.2-8.3 bars)  
 Stroke: 0.625" (1.58 cm)  
 Pull Force: 4000 lbs

### Additional Features

Trigger Acuation & Release  
 Stem Retention - FOD Control  
 Built in Pressure Relief System  
 Stroke Control  
 Accepts the FSI Rotating Adapters



### Tool Specifications

Model	NSN	Pull Force		Max Stroke		Height		Length		Diameter		Weight	
<b>PT-100</b>	5130-01-397-6805	4000 lbs	17 793 N	0.625"	1.58 cm	6"	15.2 cm	6.75"	17.1 cm	2"	5.1 cm	30 oz	850 g
<b>PT-100-C</b>	-	3750 lbs	17 793 N	0.625"	1.58 cm	5"	12.7 cm	6"	15.2 cm	2"	5.1 cm	28 oz	794 g
<b>PT-100M-CM</b>	-	4000 lbs	17 793 N	0.625"	1.58 cm	6"	15.2 cm	6.75"	17.1 cm	2"	5.1 cm	30 oz	850 g
<b>PT-100M-3700</b>	-	PT-100M + 3700 Blind Rivet Series Pulling Heads											

### Options

Description	∅	P/N
CherryMax Rotating Adapter	-	F187-AR
CherryMax Adapter Sleeve	-	F187-2AF
Jaws (3 Piece)	-	F123
DYNASWIVEL	1/4"	F15-95460
	3/32"	F156
	1/8"	F159
	5/32" & 3/16"	F143
	1/4"	F142
Nosepieces		
Extended Straight CherryMax Head	-	F1074
90° CherryMax Head	-	F1075
Offset CherryMax Head	-	F1076

### Kits

<b>PT-100-MIL-5</b>	CherryMax Riveter Kit
<b>PT-100-1</b>	Power Riveter Kit - Blind Rivets
<b>PT-100-WR/T</b>	Olympic-lok & CherryMax Riveter Kit



PT-100-MIL-5



PT-100-1



PT-100-WR/T

# Production Air Pneudraulic Riveters



**PT-747**

## Description

The New PT-747 Riveter offers high production users proven, highly reliable, air hydraulic technology coupled with a universal pulling head found on all FSI blind riveting tool systems. In seconds you can change nosepieces to accommodate a wide range of fasteners including: CherryMax® / CherryMax® SST/Huckmax®/Huck-Clinch®/Allmax®, CherryLock "A"/Olympic-lok®, Olympic Bulb-lok, Avdel® MBC, Huck SMLS, Huck and Cherry Blind Bolts (S/U Types) thru 5/32" diameter, CherryMax® AB, Cherry® "SPR" Nutplate rivets, Huck Magnalok®, Cherry Interlock®, Avdel/Cherry Monobolts®, MS20600 Self-Plugging Rivets, POP® (MIL-R-24243) Rivets, Gesipa/Olympic Bulb-tite® Rivets, Avdel AVEX® and Cherry® Q Type rivets to name just a few. Like all of our tool systems, you may add a number of adapters to enable use of special extended straight, offset, right angle and side ejection pulling heads permitting use in most any limited access area. The PT-747 tool comes with the following items: (1 ea) F143 (1/8"-3/16" CherryMax® nose), F159 (1/8" nose), F156 (3/32" nutplate nose), and F580 (3/16"MS/Interlock® nose).

## Performance

Power Source: Pnuedraulic  
 Air Pressure: 90-110 psi (6.2-7.6 bars)  
 Stroke: 0.437" (1.10 cm)  
 Pull Force: 2100 lbs

## Additional Features

Aluminum Cast Housing  
 Production Pulling Head

## Tool Specifications



Model	NSN	Pulling Force		Stroke		Air Consumption		Cycle Time	Noise Level	Weight	
PT-747	-	2100 lbs	9 341 N	0.437"	1.10 cm	0.09 SCF/cycle	2.55 l/cycle	1 s/cycle	71 dBA	3.9 lbs	1.77 kg

## Riveter Capabilities

Rivet Types	Rivet Diameters				
	3/32"	1/8"	5/32"	3/16"	1/4"
CherryMAX®, CherryMAX® 'AB', HuckMax®, Cherry SST®	-	✓	✓	✓	-
Avdel® MBC, POP® rivets	✓	✓	✓	✓	-
Cherry Interlok®, Huck Magna-Lok®, Cherry MAXIBOLT®	-	-	✓	✓	-

## Options

Description	∅	P/N
Jaws, 3 Piece	-	F123
Jaws, 2 Piece, Cast	-	F122-A
Jaw Holder	-	F126-F
Nose Tube	-	F130-F
Rotating CherryMax Adapter	-	F187-AR





# Pneudraulic Production Riveter



**PT-202F**

## Description

Reacting to the need for a high production quality blind riveter with ability to install both aerospace and industrial quality blind rivets, FSI is pleased to offer the PT-202F air hydraulic riveter. Coupling aerospace quality pneudraulic components with a well established and user friendly blind rivet nose assembly, the PT-202F offers a perfect complement to our line of limited production, field maintenance and repair riveters.

Ergonomically balanced and weighing only 5.8 lbs, the rugged metal housing will offer years of service in both high production and harsh field maintenance environments. Coming standard with a three (3) piece jaw system and two (2) popular rivet nosepieces, the PT-202F will permit the installation of a wide range of aerospace and industrial blind rivets in all materials from 3/32" thru 1/4" (including M7885/NAS9300, CherryMax®, Huck-Max® and AllMax®). Servicing the riveter is also easily accomplished with a bleeder tool that comes furnished with each riveter.

## Performance

Power Source: Pneudraulic  
 Air Pressure: 90-110 psi (6.2-7.6 bars)  
 Stroke: 0.750" (1.90 cm)  
 Pull Force: 3889 lbs

## Additional Features

Installs most all Aerospace and Commercial straight pull blind Rivets from 3/32" thru 1/4" diameter

## Tool Specifications



Model	NSN	Pull Force		Stroke		Height		Length		Diameter		Weight	
PT-202-F	-	3889 lbs	17 299 N	0.750"	1.90 cm	12.5"	31.7 cm	9.75"	24.8 cm	5.38"	13.7 cm	5.8 lbs	2.6 kg

## Riveter Capabilities

Rivet Types	Rivet Diameters				
	3/32"	1/8"	5/32"	3/16"	1/4"
<b>C h e r r y M A X ® , CherryMAX® 'AB', HuckMax®, Cherry SST®</b>	-	✓	✓	✓	✓
<b>Avdel Interlok®, Huck Magna-Lok®, POP®</b>	-	-	✓	✓	✓

## Options

Description	∅	P/N
Rotating CherryMax Adapter	-	F187-AR
Extended Straight CherryMax Head	-	F1074
90° CherryMax Head	-	F1075
Offset CherryMax Head	-	F1076

# Pneumatic Rivnut Installation Tool



**PT-7421**

## Description

Weighing less than 5 lbs, the PT-7421 Air Operated Spin Pull to Pressure Nutsetter has evolved from the production tested reliable stroke adjustable version, the 7420. With pull force adjustment capability, the PT-7421 allows the user to insure that the force imparted to the fastener will not exceed the bearing strength of the material it is being installed into (ie. fiberglass, wood, composites) or the thread of the fastener itself. This feature significantly reduces the potential for damage or excessive wear to the pull up stud (mandrel) and anvil assembly due to material thickness variations. Affording a 0.275" stroke, the PT-7421 is capable of installing virtually all blind nut and inserts within its capacity range in one stroke, including Rivnuts® (NAS1329, NAS1330, MS27130), Plusnuts®, AVK ribbed inserts and Blind Nuts, Avdel Nutserts and Thin Sheet Nutserts® (TSN). Importantly, if the user inadvertently recycles the riveter after installation, the fastener threads and/or parent material remain unaffected. Utilizing standard Grade 8 Socket Head Cap Screws as pull up studs (mandrels) reduces replacement cost and permits wide flexibility for adapting to different fastener lengths. The driving anvil assembly is adjustable to permit quick adaption to most all standard blind rivet nuts or inserts.

## Performance

Power Source: Pneumatic  
 Air Pressure: 75-100 psi (4.8-6.9 bars)  
 Stroke: 0.275" (0.69 cm)  
 Pull Force: 3960 lbs

## Additional Features

Adjustable Pull Pressure  
 Installs Rivnuts & Inserts from 4-40 to 5/16-24

## Tool Specifications



Model	NSN	Pull Force		Stroke		Air Consumption		Cycle Time	Noise Level	Vibration
PT-7421	-	3 960 lbs	17615 N	0.275"	0.69 cm	0.264 CFM/cycle	0.3 l/cycle	2.5 s/cycle	75 dBa	< 2.5 m/s
						Height	Length	Diameter	Weight	
						11.61"	29.5 cm	11.81"	30 cm	3.95" 10 cm 5 lbs 2.3 kg

## Tool Capabilities

Fastener Types	Thread Size Range
	4-40 thru 5/16-24 or 10mm

Rivnuts®, Plusnuts®, AVK® Inserts & Avdel® ✓

## Kits

D-7421-MIL-1	Blind Rivet Nut Insert Kit (Pneumatic & Hand Tools)
PT-7421-N	Blind Rivet Nut Insert Kit (6-32 to 5/16-24 Sizes)



D-7421-MIL-1



# 3 Cordless Riveters



## Contents

Riveters  
Accessories

## Fastener Installation Procedure

- Insert rivet into the hole
- Place the riveter pulling head over the rivet stem
- Hold the riveter in line with the axis of the rivet
- Actuate the riveter by pulling the trigger, the action of the riveter will automatically align the rivet to the work surface
- The rivet stem will be ejected into the rear canister of the tool

## Selecting the Correct Tool

### Tool Selection:

To ensure proper tool selection, answer the following questions:

- What type of rivets are you installing?
- What is the diameter of the rivet?
- What are your pull force requirements?
- Do you have any restraints?



## Typical Use

The PT-3000 & PT-4000 cordless riveters allow the installation of the types of blind rivets commonly used in the aviation industry (Huck ®, Cherry ®, Olympic ®, Avdel ® and Pop ®).

These tools are also capable of installing most commercial straight pull blind rivets up to 1/4" diameter. The FSI cordless riveters are used in many industries such as truck & trailer, automotive, rail and marine.





# Portable Cordless Riveters



**PT-3000  
Aerospace**



**PT-3000-C  
Commercial**

## Description

If you are needing to blind rivet the cowling of a jet aircraft, the galley in a nuclear submarine, a HMMWV body panel, the tail boom of a helicopter, or the air conditioning duct in an office building and you are in a remote location without convenient power sources, the PT-3000 will help make your blind riveting job go quicker, easier, and more cost effective than any other system.

Falling within the scope of the USAF TO-1-1-688, the PT-3000 is now being used for routine aircraft sheet metal repair wherever 12 VDC portable equipment is permitted. Developing in excess of 1,900 lbs of pulling force, the PT-3000 is able to install virtually all straight pull blind rivets from 3/32" thru 3/16" diameter and even some all aluminum 1/4" diameters.

## Performance

Power Source: Nickel-Metal Battery 12V, 3.2 Ah  
 Chargers: 120V, 60Hz or 220V, 50Hz  
 Charge Time: 30 minutes  
 Stroke: 0.787" (1.99 cm)  
 Pull Force: 2000 lbs

## Additional Features

Interchangeable Nosepieces  
 Ergonomically Balanced  
 Operating Temperature Protection  
 Positive Stroke Control  
 No Stem Jamming

## Tool Specifications



Model	NSN	Pull Force		Stroke		Height		Length		Diameter		Weight	
PT-3000	5130-01-397-7379	2000 lbs	8 451 N	0.787"	1.99 cm	11.86"	30.1 cm	10.36"	26.3 cm	2.62"	6.7 cm	4.8 lbs	2.2 kg
PT-3000-C	-	2000 lbs	8 451 N	0.787"	1.99 cm	11.86"	30.1 cm	10.36"	26.3 cm	2.62"	6.7 cm	4.8 lbs	2.2 kg

## Riveter Capabilities

### PT-3000 (Aerospace Rivets)

Rivet Types	Rivet Diameters				
	3/32"	1/8"	5/32"	3/16"	1/4"
CherryMAX®, CherryMAX® 'A', Nut-plate	✓	✓	✓	✓	-
Avdel® MBC, POP® rivets	✓	✓	✓	✓	-
Cherry Interlok®, Huck Magna-Lok®	✓	✓	✓	✓	-

### PT-3000-C (Commercial/Industrial Rivets)

Rivet Types	Rivet Diameters				
	3/32"	1/8"	5/32"	3/16"	1/4"
MonoBolts®	-	-	-	✓	-
Huck Magna-Lok®	-	-	-	✓	-
Gesipa Non-Structural®	✓	✓	✓	✓	-
Avdel Avex®	-	✓	✓	✓	-



Options

Description	∅	PT-3000	PT-3000-C
Charger	-	F-4000A	F-4000A
Battery Pack	-	F-3001A	F-3001A
Rotating Adapters	CherryMax	F187-AR	F187-AR
	Olympic-Lok®	F687-AR	F687-AR
Standard Adapters	CherryMax	F3187	F187
	Olympic-Lok®	F687	F687
Jaws, 3 Piece	-	F123	F3123
Jaw Follower	-	F3621	F3621
Jaw Follower Spring	-	F3093	F3093
Nosepieces	3/32" Nutplate	F156	F156
	1/8"	F159	F159
	1/8" & 5/32"	F140	F140
	3/16"	F143, F168 & F580	F143, F168 & F580
	1/4"	F142	F142
Extended Straight CherryMax Head	-	F1074	F1074
90° CherryMax Head	-	F1075	F1075
Offset CherryMax Head	-	F1076	F1076



Kits

PT-3000-MIL-1	Universal Cordless Riveter Kit
PT-3000-MIL-2	CherryMax Cordless Riveter Kit
PT-3000-G	Commercial Riveter Kit



PT-3000-MIL-1



PT-3000-MIL-2



PT-3000-G

# Portable Cordless Riveters



PT-4000



PT-4000H

## Description

The new higher capacity PT-4000 cordless blind riveter offers the sheet metal technician capability for installation of most all 1/4" diameter blind rivets while retaining all the features of the PT-3000 with respect to size, weight and versatility.

Falling within the USAF TO-1-1-688 spec, the PT-4000 develops in excess of 3,000 lbs of pulling force over more than 3/4" of stroke. Utilizing the same battery packs and charger as the PT-3000 riveter, the PT-4000 is a logical addition for any organization normally requiring 1/4" diameter blind riveting capability. The standard PT-4000 pulling head assembly is interchangeable with any of the FSI riveters, therefore offering redundancy and reduced spare parts.

Types of rivets installable with the PT-4000 include, but are not limited to, virtually all CherryMax (M7885), Avdel or Cherry Monobolts®, Cherry Interlock®, Huck Magna-Lok® and POP® type rivets. The PT-4000 is also capable of installing both 5/32" and 3/16" Blind Bolts (MS90353/54-S/U) with the proper nosepieces (provided in the MIL-1 and MIL-2 kits).

## Performance

Power Source: Nickel-Metal Battery 12V, 3.2 Ah  
 Charger: 120V, 60Hz or 220V, 50Hz  
 Charge Time: 30 minutes  
 Stroke: 0.787" (1.99 cm)  
 Pull Force: 5000 lbs

## Additional Features

Interchangeable Nosepieces  
 Ergonomically Balanced  
 Operating Temperature Protection  
 Positive Stroke Control  
 No Stem Jamming

## Tool Specifications



Model	NSN	Pull Force		Stroke		Height		Length		Diameter		Weight	
PT-4000	-	4000 lbs	17793 N	0.787"	1.99 cm	11.86"	30.1 cm	10.36"	26.3 cm	2.62"	6.7 cm	4.8 lbs	2.2 kg
PT-4000H	-	5000 lbs	22241 N	0.787"	1.99 cm	11.86"	30.1 cm	6.81"	17.3 cm	2.62"	6.7 cm	4.96 lbs	2.25kg

### PT-4000-FX

The PT-4000-FX is a dedicated riveter with a 19" extension which has a 15° Flex.



**SAFETY:** Read and follow all safety instructions  
**WARNING:** The safety guards are mandatory

## Riveter Capabilities

## PT-4000

Rivet Types	Rivet Diameters				
	3/32"	1/8"	5/32"	3/16"	1/4"
CherryMAX®, Huck CLINCH®, AIIMAX® CherryMAX® 'A'	-	✓	✓	✓	✓
Avdel® MBC, POP® rivets	✓	✓	✓	✓	✓
Interlok®, Magna-Lok®, Mega-Grip®, Monobolt®, Olympic Bulb-Tite®	-	-	-	✓	✓
AVEX®	-	✓	✓	✓	✓
Magna-Bulb®, Hemlok®	-	-	-	-	✓
Cherry® & Olympic® MS, Cherry-Lok® 'A'	✓	✓	✓	✓	-
Maxi-Bolt®	-	-	✓	✓	-

## PT-4000H

Rivet Types	Rivet Diameters				
	3/32"	1/8"	5/32"	3/16"	1/4"
CherryMAX®, Huck CLINCH®, AIIMAX® CherryMAX® 'A', SMLS UNIMATIC®	-	✓	✓	✓	✓
Olympic-Lok®	✓	✓	✓	✓	✓
ASP®, MS Blind Bolts (MS90353/54 & MS21140/41 S & U Type)	-	-	✓	✓	✓

## PT-4000-FX

Rivet Types	Rivet Diameters				
	3/32"	1/8"	5/32"	3/16"	1/4"
CherryMAX®	-	✓	✓	✓	-

## Options

Description	∅	PT-4000 PT-4000H	PT-4000-FX
Charger	-	F-4000A	F-4000A
Battery Pack	-	F-3001A	F-3001A
Rotating Adapters	CherryMax	F187-AR	-
	Olympic-Lok®	F687-AR	-
Standard Adapters	CherryMax	F3187	-
	Olympic-Lok®	F687	-
Jaws, 3 Piece, Sets	-	F123	-
	5/32" Blind bolt	F123-A	-
	3/16" Blind bolt	F123-B	-
Jaw Follower	-	F3245	-
Jaw Holder	Blind bolt	F128	-
Nosepieces	5/32" & 3/16"	F143	-
	1/4"	F142	-
Nosepieces (MaxiBolt)	5/32"	F505(-MB)	-
	3/16"	F506(-MB)	-
Extended Straight CherryMax Head	-	F1074	F1074
90° CherryMax Head	-	F1075	F1075
Offset CherryMax Head	-	F1076	F1076

## Kits

PT-4000-MIL-1	Cordless Blind Riveter Kit
PT-4000-MIL-2	Cordless Blind Riveter Kit w/CM Heads



PT-4000-MIL-1



PT-4000-MIL-2



## Accessories

### Battery Pack



P/N	Composition	Voltage	Amps	Charge Time
F-3001A	Nickel/Metal	12 V	3.2 Ah	1 hour

### Charger



P/N	Voltage	Frequency
F-4000A	120 V	60 Hz
F-4000A/220	220 V	50 Hz



# Manual Riveters 4



## Contents

Hand Hydraulic Riveters  
Hand Mechanical Riveter

## Fastener Installation Procedure

- Insert the blind rivet into the prepared hole and place the riveter over the stem
- Manually pump the riveter by pulling the handles together to complete the installation, allowing the handles to go back to its original position between each movement.
- Press the release button and remove the broken stem from the front of the tool.

## Selecting the Correct Tool

### Tool Selection:

To ensure proper tool selection, answer the following questions:

- What type of rivets are you installing?
- What is the diameter of the rivet?
- What are your pull force requirements?
- Do you have any restraints?



## Tool Development

In order to meet the growing demands of modern assembly operations, FASTENING SYSTEMS INTERNATIONAL is always on the cutting edge of technology. Innovation, ergonomics and versatility are key drivers of our design team.

Each tool is developed to improve productivity to our customers. Our philosophy leads us to believe that each operator deserves the best tools that will help them complete their task in an efficient and timely manner.

## Typical Use

The D-700C can be easily adapted to install wire draw rivets thru 3/16" diameter including CherryMax® "A", InterMax®, Avdel MBC, Cherrylock® "A" Code, and Cherry Interlock® blind rivets. The D-700C riveter also comes with the Vari-Max™ adjustable pressure control to permit setting of pulling force when installing blind threaded fasteners.



# Hand Hydraulic Riveters



D-180



D-100-C

## Description

Since the introduction of the D-100 riveter in 1983, FSI Blind Riveter installation tools have been an industry standard in the aerospace/military field. Designed to meet the varied blind fastening needs of the aircraft repair specialist, the D-180 series hand hydraulic riveter provides a unique blend of power, versatility and compact size never before available in a hand tool. Originally designed for military applications, the D-180 series tools can be used on commercial airlines, general aviation, helicopter fleets as well as aerospace vehicles. The D-180 can install single pull blind rivets up to 1/4" diameter and creates a pull force of over 5000 lbs.

The D-100-C will install blind rivets up to 1/4" diameter (including automotive split rivets, Monobolts®, and Huck Magna-Lok®) and blind rivet nuts up to 3/8" Aluminum and 1/4-20" or 6mm steel. Requiring no external power, the D-100 series riveters are ideally suited for any limited production or repair operation. Because of the lightweight and compact size, the riveters can be used in limited access areas where other riveters often require very costly adaptive tooling. With the D-100-C you are ready to repair, restore, maintain, or customize automobiles, vans, buses, RVs, boats and small aircraft.

## Performance

Power Source: Hand Hydraulic  
 Stroke: D-180 = 0.825" (2.09 cm)  
           D-100-C = 0.625" (1.58 cm)  
 Pull Force: D-180 = 5000 lbs

## Additional Features

Adjustable Lever  
 Ergonomic Handles  
 Light Weight  
 Powerful

## Tool Specifications



Model	NSN	Pull Force	Stroke	Height	Length	Diameter	Weight
D-180	5120-01-430-5350	5000 lbs 22241 N	0.825" 2.09 cm	6-1/4" 15.9 cm	9-1/2" 24.13 cm	1-3/4" 4.4 cm	20.5 oz 581 g
D-100-C	-	3750 lbs 16700 N	0.625" 1.58 cm	6-1/4" 15.9 cm	9-1/2" 24.13 cm	1-3/4" 4.4 cm	20.5 oz 581 g

## Riveter Capabilities

### D-180 (Aerospace Rivets)

Rivet Type	Rivet Diameters				
	3/32"	1/8"	5/32"	3/16"	1/4"
CherryMAX®	✓	✓	✓	✓	✓
HuckCLINCH®	✓	✓	✓	✓	✓
Maxibolts®	-	-	✓	✓	-

### D-100-C (Commercial Rivets)

Rivet Type	Rivet Diameters				
	3/32"	1/8"	5/32"	3/16"	1/4"
MonoBolts®	-	-	-	✓	✓
Huck Magna-Lok®	-	-	-	✓	✓

**SAFETY:** Read and follow all safety instructions  
**WARNING:** The safety guards are mandatory





Options

Description	Ø	D-180	D-100-C
Cherry Adapter	-	F187	-
MS Adapter	-	F687	-
Nosepieces	3/32"	F156	F156-C
	1/8"	F159	F159-C
	5/32" & 3/16"	F143	F143-C
	1/4"	F142	F142-C
"T" Rivet Nosepiece	1/4"	-	F155
Driving Anvils	#6	F367	F367-C
	#8	F364	F364-C
	#10	F365	F365-C
	1/4"	F366	F366-C
	5/16"	F378	-
	3/8"	F379	-
TSN Driving Anvils	#10	F176	F176-C
	1/4"	F177	F177-C
Pull-Up Studs	6-32	F1 (F360)	F360-C
	8-32	F2 (F361)	F361-C
	10-32	F3 (F362)	F362-C
	1/4-28	F4 (F363)	F363-C
	10-24	F5 (F372)	F372-C
	1/4-20	F6 (F373)	F373-C
	5/16-18	F7 (F374)	-
	3/8-16	F8 (F375)	-
	6 mm	F380	F380
Master Shaft	-	F170-A	F170-A
Turn Nut	-	F171	F171-C
Extended Straight CherryMax Head	-	F1074	-
90° CherryMax Head	-	F1075	-
Offset CherryMax Head	-	F1076	-

D-180 Kits

- D-100-MII-1** Hand Hydraulic Riveter Kit
- D-100-MII-2** Hand Hydraulic Riveter Kit w/ CM Heads
- D-100-R** Aerospace Blind Riveter Kit



D-100-MIL-1



D-100-MIL-2



D-100-R

D-100-C Kits

- D-100-C** Commercial Blind Riveter Kit
- D-100-RNA** Automotive Blind Riveter Kit
- D-100-N** Rivnut Installation Kit
- D-100-RN** Combination Riveter/Nutsetter Kit



D-100-C



D-100-RNA



D-100-N



D-100-RN

# Hand Hydraulic Riveters

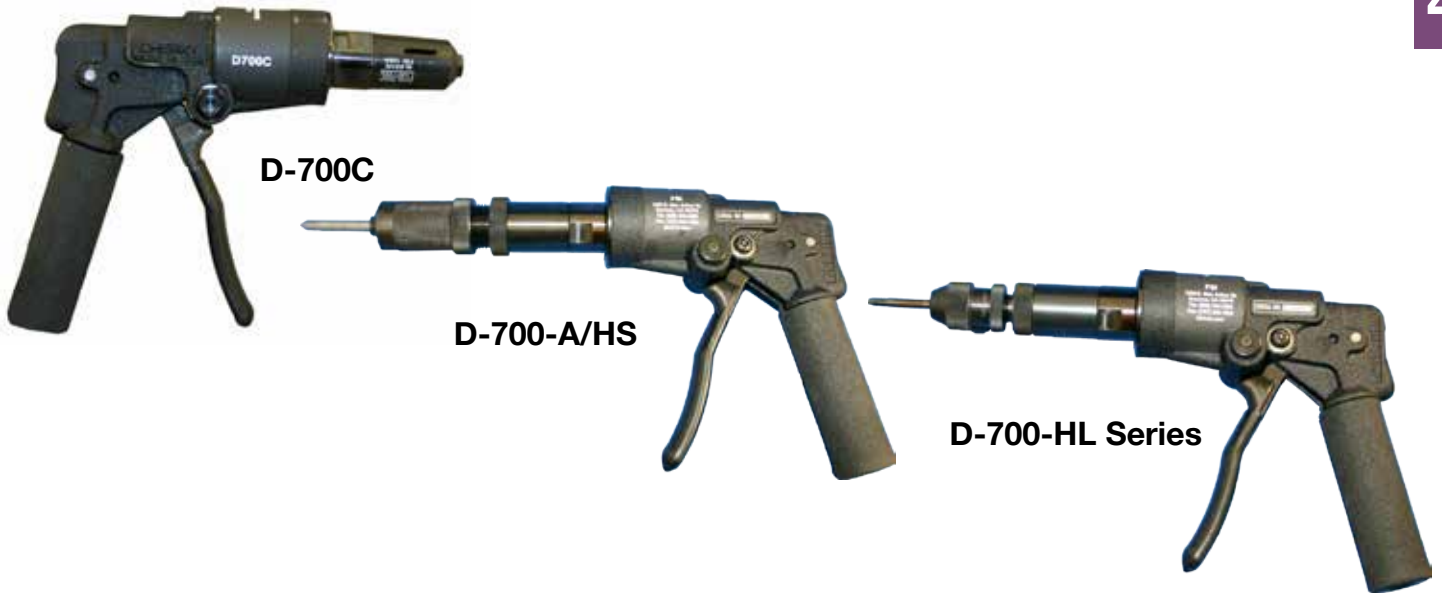

## Description

Evolving from the highly successful blind riveter, the D-700A / D-700-VM, the new D-700C addresses user needs for an even more versatile, powerful, reliable, and field repairable tooling system. A new smart valve permits a greatly reduced wrist effort for installation of a wide variety of straight pull blind fasteners including all CherryMax® style (M7885) blind rivets, Cherry blind bolts (MS90353/54S/U) (thru 3/16" dia.), Rivnuts® thru 3/8" and most blind inserts. The D-700C riveter is provided with the Vari-Max™ adjustable pressure control to permit precise setting of pulling force when installing blind rivet nut fasteners. The D-700C may be used with any of the nosepieces and accessories supplied in the D-100 series kits.

## Tool Specifications

Model	NSN	Pull Force		Stroke		Height		Length		Diameter		Weight	
D-700C	5120-01-397-6806	5000 lbs	22 241 N	0.8"	2.03 cm	6.56"	16.7 cm	7.50"	19 cm	2"	5.1 cm	1.95 lbs	884 g
D-700-A/HS	-	4800 lbs	21 351 N	0.8"	2.03 cm	6.56"	16.7 cm	11.2"	28.44 cm	2.465"	6.3 cm	2.65 lbs	1.2 kg
D-700-HL	-	4800 lbs	21 351 N	0.8"	2.03 cm	6.56"	16.7 cm	7.50"	19 cm	2"	5.1 cm	1.95 lbs	884 g

## Riveter Capabilities

### D-700C

Rivet Type	Rivet Diameters				
	3/32"	1/8"	5/32"	3/16"	1/4"
Rivets POP®	✓	✓	✓	✓	✓
Rivets MAGNALOK®, MONOBOLTS®, Olympic Bulb-Tite®	-	-	-	✓	✓
Rivets MAGNABULB®, HEMLOK®	-	-	-	-	✓
Rivets CherryMAX®, MAXIBOLT®, CherryLOK 'A', HuckCLINCH®, AII MAX®, AVEX®	-	✓	✓	✓	✓
Rivets Cherry MS Rivets Olympic MS	✓	✓	✓	✓	-

### D-700-A/HS & D-700-HL Series

Rivet Type	Thread Sizes			
	6-32 UNC	8-32 UNC	10-24 UNC	10-32 UNF
Rivnuts® Rivetless Nutplates	✓	✓	✓	✓
Shur-Lok® Inserts Elliptical Nuts	✓	✓	✓	✓



**SAFETY:** Read and follow all safety instructions  
**WARNING:** The safety guards are mandatory



**Options**

Description	Ø	D-700-C	D-700-365HL	
Rotating Adapter	-	F187-AR	-	
MS Adapter	-	F687	-	
Nutplate Nosepiece	3/32 - 1/8"	F156	-	
CherryMax Nosepieces	5/32 - 3/16"	F143	-	
	1/4"	F142	-	
	1/8"	F159	-	
Maxibolt Nosepieces	5/32"	F505U	-	
	3/16"	F506	-	
Pull-Up Studs	6-32	F360	F360-6	
	8-32	F361	F361-6	
	10-32	F362	F362-6	
	1/4-28	F363	F363-6	
	5/16-24	F377	-	
	10-24	F372	-	
	1/4-20	F373	-	
	5/16-18	F374	-	
	3/8-16	F375	-	
	6 mm	F380	-	
	Driving Anvils	#6	F367	-
		#8	F364	F364HL
#10		F365	F365HL	
#10 TSN		F176	-	
1/4"		F366	F366HL	
1/4" TSN		F177	-	
5/16"		F378	-	
3/8"	F379	-		
Master Shaft	-	F170-A	F170-A	
Turn Nut	-	F171	F171-365HL	
Rotating CherryMax Adapter	-	F187-AR	-	
Extended Straight CherryMax Head	-	F1074	-	
90° CherryMax Head	-	F1075	-	
Offset CherryMax Head	-	F1076	-	
Jaws, 3 Piece, Blind Bolts	5/32"	F123-A	-	
	3/16"	F123-B	-	
Blind Bolt Jaw Holder	-	F128	-	
Blind Bolt Jaw Pusher	-	F758	-	

**Performance**

Power Source: Hand Hydraulic  
 Stroke: 0.8" (20.3 mm)  
 Pull Force: 5000 lbs

**Additional Features**

Vari-MAX™ Pressure Control  
 Ergonomic Handles  
 Light Weight & Powerful

**D-700C Kits**

P/N	Description	D-700-C
<b>D-700-N</b>	Rivnut Installation Kit	✓
<b>D-700-MIL-2</b>	CherryMax, Maxibolt & Rivnut Installation Kit	✓
<b>D-700-MIL-4</b>	CherryMax Installation Kit	✓



D-700-N



D-700-MIL-2



D-700-MIL-4



The Vari-Max™ system present on all the D-700C series tools allows the user to adjust the pull force during the installation of blind rivet nut fasteners (Rivnuts, nutserts, inserts) to ensure proper installation without damaging the threads of the insert. The pull force can be adjusted from 800 to 5000 lbs. This Vari-Max™ is located on the tool on the side opposite the release button.



# Hand Mechanical Riveter



**D-28**

## Description

The FSI D-28 Hand Mechanical Riveter is an efficient, compact, lightweight tool for installing Pop-type, CherryMax® and Cherry Nut Plate rivets. It comes equipped with the F159-CH, which installs 1/8" rivets (on the tool), the F143-CH nosepiece to install 3/16" rivets and the F156-NP nosepiece to install nut plate rivets which are located in the handle. To operate, first insert rivet stem into nosepiece. Insert rivet into work with riveter nosepiece held firmly and squarely against the head of the rivet. Maintain a steady pressure against rivet head and squeeze the handles to install the rivet. An additional stroke may be necessary depending on the rivet length and the thickness of the material being joined.

## Performance

Power Source: Manual  
Includes 3 Nosepieces

## Additional Features

Compact  
Light Weight  
Nosepiece Storage in the Handle

## Tool Specifications

Model	NSN	Pull Force			Stroke		Height		Length		Diameter		Weight	
D-28	-	-	-	-	-	-	9.25"	23.5 cm	5-5/16"	13.3 cm	-	-	13 oz	368 g

## Riveter Capabilities

Rivet Type	Rivet Diameters				
	3/32"	1/8"	5/32"	3/16"	1/4"
Rivets POP®	✓	✓	✓	✓	-
Rivets AVEX®	-	✓	✓	-	-
Rivets CherryMAX®, HuckCLINCH®, AII MAX®	-	✓	✓	-	-

## Options

Description	∅	D-28
Nosepieces	1/8"	F159-CH
	5/32";3/16"	F143-CH
NutPlate Nosepiece	3/32";1/8"	F156-NP





# Kits & Accessories



## Contents

Kits  
Accessories

## Sheet Metal Mechanics Tool Kit

P/N: K-2000

NSN: 5180-01-586-1890



### Description

Introducing the K-2000 Sheet Metal Mechanics Tool Kit. Developed for Unit Level maintenance for Army Aviation, this kit includes all the most current Aerospace tools for Fastener Removal, Surface Preparation and Fastener Installation for Blind Rivets (CherryMax®), Blind Bolts, Solid AD Buck Rivets, Jo-Bolts and Hi-Loks from 3/32" to 1/4" diameter. This A to Z Sheet Metal kit compliments BDR and DART kits and is fully mobile for deployment. This kit is housed in a Hardigg®, US Army Approved Transportation Cases, equipped with casters and extra carry handles.

### Key Features

- |   |  |
|---|--|
| <ul style="list-style-type: none"> <li>1 Cordless Riveter w/ CED Blind Bolt Heads</li> <li>1 D-700-MIL-2 Riveter Kit</li> <li>2 Pistol Sytle Drills (2600 &amp; 4000 rpm)</li> <li>1 3X Rivet Hammer</li> <li>1 5" Orbital Sander</li> <li>Threaded and Chucking Cobalt Drill Bits</li> </ul> | <ul style="list-style-type: none"> <li>1 90° Threaded Drill</li> <li>1 Jo-Bolt® Installation &amp; Removal Kit</li> <li>1 Hi-Lok® Installation &amp; Removal Kit</li> <li>1 Micro-stop Countersink Kit</li> <li>Clecos, Side Clamps, Hole Finders</li> </ul> |
|---|--|

P/N: K-1000

NSN: 5180-01-586-1897

### Description

The K-1000 Sheet Metal Mechanics Tool Kit is comprised of 3 kits; the Removal (K-1000-1), Preparation (K-1000-2) and Installation (K-1000-3). These three kits combine to give the end user at the organizational level intermediate capabilities. The user is able to work with NAS Solid Rivets, Blind Rivets, Hi-Loks, Jo-Bolts and MS Blind Bolts through 1/4" diameter.

### Capabilities

Installation and Removal: Up to 1/4" Diameter

- 1. Blind Rivets
- 2. Solid AN Rivets
- 3. NAS Jo-bolts
- 4. Hi-loks
- 5. Blind Bolts



**SAFETY:** Read and follow all safety instructions  
**WARNING:** The safety guards are mandatory



**P/N: K-2000-MIL-1**  
**NSN: 5180-01-585-7545**

**Description**

Introducing the K-2000-MIL-1 Sheet Metal Mechanics Tool Kit. Developed for Unit Level maintenance, this two box system includes all the most current Aerospace tools for Fastener Removal, Surface Preparation and Fastener Installation for Blind Rivets (CherryMax®), Blind Bolts, Solid AD Buck Rivets, Jo-Bolts and Hi-Loks from 3/32” to 1/4” diameter. This kit also includes a 110 volt Electric - Hand Carry 1.1 Hp Dual Storage Tank Compressor for multiple tool operation. This kit is housed in two Hardigg®, US Army Approved Transportation Cases, equipped with casters and extra carry handles.



**Capabilities**

Installation and Removal: Up to 1/4” Diameter

1. Blind Rivets
2. Solid AN Rivets
3. NAS Jo-bolts
4. Hi-loks
5. Blind Bolts

**Contents**

**Tray 1**

Qty	Description	P/N	Qty	Description	P/N
1	Sheet Metal Gauge	F15	1	518-J Nutplate Jig	F518-J
1	Telescoping Deburr Tool	K380	1	518-NB Nutplate Jig	F518-NB
1	Double Edge Deburr Tool	F22060	1	518-NC Nutplate Jig	F518-NC
1	Camloc Pliers	F4P3	1	518-ND Nutplate Jig	F518-ND
1	Hole Finder, Bushing Type	ALHF-1/4	1	518-PB Nutplate Jig	F518-PB
1	Hole Finder, Bushing Type	ALHF-10	1	518-PC Nutplate Jig	F518-PC
1	Hole Finder, Bushing Type	ALHF-21	1	518-PD Nutplate Jig	F518-PD
1	Hole Finder, Bushing Type	ALHF-30	1	Chip Chaser	F200
1	Hole Finder, Bushing Type	ALHF-40	1	Pancake Drill Attachment	F20-T023
1	Hole Finder, Bushing Type	ALHF-1/4-I	5	Side Clamp 3/4-1	F123SG
1	Hole Finder, Inverted Type	ALHF-10-I	5	Side Clamp 3/4-1/2	F1212SG
1	Hole Finder, Inverted Type	ALHF-21-I	1	Unibit #1 (1/2” - 1/8”)	F10101
1	Hole Finder, Inverted Type	ALHF-30-I	1	Unibit #2 (1/2” - 3/8”)	F10102
1	Hole Finder, Bushing Type	ALHF-40-I	1	Unibit #3 (3/4” - 1/8”)	F10103
1	90° Die Grinder	FDG221-90	20	Clecos #40	FK-3/32
1	518-A Nutplate Jig	F518-A	20	Clecos #30	FK-1/8
1	518-B Nutplate Jig	F518-B	20	Clecos #20	FK-5/32
1	518-C Nutplate Jig	F518-C	20	Clecos #10	FK-3/16
1	518-G Nutplate Jig	F518-G	1	Cleco Pliers	F74
1	518-H Nutplate Jig	F518-H			



# Kits

5



Tray 2

Qty	Description	P/N
1	Chisel Retaining Spring	F2207
1	Die Grinder, Air, 1/4" Collet	FDG10S25F
1	1/4" Collar Remover	ALRCC-1/4
1	3/16" Collar Remover	ALRCC-3/16
1	5/32" Collar Remover	ALRCC-5/32
1	1/8" Collar Remover	ALRCC-1/8
1	Bucking Bar	FBB760B-2
1	Bucking Bar	FBB769
1	Bucking Bar	FBB720
1	Hook & Pick Set	PH-4
1	8 Piece Drive Pin Set	F14086
1	Sanding Disk Kit	SDK-15
1	Rivet Set, 1/4", AN470	ALRS-1/4-3.5
1	Rivet Set, 1/4", AN470, Offset	ALRS-1/4-3.5-O
1	Rivet Set, 3/16", AN470	ALRS-3/16-3.5
1	Rivet Set, 3/16", AN470, Offset	ALRS-3/16-3.5-O
1	Rivet Set, 5/32, AN470	ALRS-5/32-3.5
1	Rivet Set, 5/32, AN470, Offset	ALRS-5/32-3.5-O
1	Rivet Set, 1/8", AN470	ALRS-1/8-3.5
1	Rivet Set, 1/8", AN470, Offset	ALRS-1/8-3.5-O
1	Rivet Set, 3/32", AN470	ALRS-3/32-3.5
1	Rivet Set, 3/32", AN470, Offset	ALRS-3/32-3.5-O
1	Rivet Set, Flat	ALRS-F-3.5
1	Rivet Set, Flat, Offset	ALRS-F-3.5-O
1	Rivet Set, 3/4", Mushroom	ALRS-3/4F RG
1	5/32" Knock Out Punch	ALRGP-5/32-L
1	3/16" Knock Out Punch	ALRGP-3/16-L

Qty	Description	P/N
1	1/4" Knock Out Punch	ALRGP-1/4-L
1	5/32" Hi-Lok Removal Socket	AL-HLC-5
1	3/16" Hi-Lok Removal Socket	AL-HLC-6
1	1/4" Hi-Lok Removal Socket	AL-HLC-8
1	3/16" Hi-Shear Collar Cutter	ALCC-3/16
1	1/4" Hi-Shear Collar Cutter	ALCC-1/4
1	5/16" Hi-Shear Collar Cutter	ALCC-5/16
5	2" Abrasive Pads 60 Grit	F587-60
5	2" Abrasive Pads 120 Grit	F587-120
5	2" Abrasive Pads 240 Grit	F587-240
5	2" Abrasive Pads 320 Grit	F587-320

**SAFETY:** Read and follow all safety instructions  
**WARNING:** The safety guards are mandatory





Tray 3



Qty	Description	P/N
1	Hi-Lok Installation & Removal Kit	F3539A-8
1	90° Threaded Drill	FSD2800-90T
1	45° Threaded Drill	FSD2800-45T
1	Drill Bushing Kit	F590DBK
12	#10 Jobber Drill	ALJBD-10
12	#21 Jobber Drill	ALJBD-21
12	#30 Jobber Drill	ALJBD-30
12	#40 Jobber Drill	ALJBD-40
12	1/4" Jobber Drill	ALJBD-1/4
6	#27 Jobber Drill	ALJBD-27
6	#16 Jobber Drill	ALJBD-16
6	#5 Jobber Drill	ALJBD-5
6	#19 Jobber Drill	ALJBD-19

Qty	Description	P/N
6	#7 Jobber Drill	ALJBD-7
6	G Jobber Drill	ALJBD-G
1	Angle Drill Collet Kit	ALAC-6
6	#10 Threaded Drill, Short	ALTD-10-S
6	#10 Threaded Drill, Medium	ALTD-10-M
6	#10 Threaded Drill, Long	ALTD-10-L
6	#21 Threaded Drill, Short	ALTD-21-S
6	#21 Threaded Drill, Medium	ALTD-21-M
6	#21 Threaded Drill, Long	ALTD-21-L
6	#30 Threaded Drill, Short	ALTD-30-S
6	#30 Threaded Drill, Medium	ALTD-30-M
6	#30 Threaded Drill, Long	ALTD-30-L

Qty	Description	P/N
6	#40 Threaded Drill, Short	ALTD-40-S
6	#40 Threaded Drill, Medium	ALTD-40-M
6	#40 Threaded Drill, Long	ALTD-40-L
6	1/4" Threaded Drill, Short	ALTD-1/4-S
6	1/4" Threaded Drill, Medium	ALTD-1/4-M
6	1/4" Threaded Drill, Long	ALTD-1/4-L
2	2" Threaded Drill Extension	ALTE2
2	4" Threaded Drill Extension	ALTE4
1	Dimple Die Set	F3456
1	Multi Edge Deburr Tool	F22060

Tray 4



Qty	Description	P/N
1	Air Vac	F4580
1	Rivet Cutter	F501-R
1	90° Snake Drill	F128-4
1	Drill, Pistol, 4000 RPM	FDR4000
1	Micro-Stop Countersink Kit	F590
1	Rivet Fan Spacing Tool	F081
1	Drill Gauge	F20
1	Drill, Pistol, 2600 RPM, Reversible	FSD2600R
1	Rev Countersink/Counterbore Kit	F590STA
1	Hand Rivet Squeezer w/3 Yokes	F420-123A

Tray 5

Qty	Description	P/N
1	Jo-Bolt Installation & Removal Kit	F3060RIK
1	Jig Saw, Air Powered	FS0822
1	Rotary File Kit	F912
1	5" Orbital Sander	FOS-50CNP
1	Bucking Bar	FBB111
1	Bucking Bar	FBB670
1	Cordless Riveter w/CherryMax CED	PT-4000H-CM
1	5/32 Close Edge Blind Bolt Head	F4301-5CED
1	3/16 Close Edge Blind Bolt Head	F4307-6CED
1	1/4 Close Edge Blind Bolt Head	F4313-8CED
1	Battery Charger	F-4000A
1	Blind Riveter Kit	D-700-MIL-2
1	Rivet Set Kit	F26
1	3X Rivet Hammer	FRG-3X
1	Battery Pack	F3001-A
1	Hand Hydraulic Riveter	D-180



## Fastener Removal Kit

P/N: K-1000-1

NSN: 5180-01-584-5839



### Description

The FSI Sheet Metal Fastener Removal Kit is equipped with everything necessary to remove all airframe fasteners up to 1/4" diameter. These fastener types include Blind Rivets & Blind Bolts, Solid AD fasteners, Jo-Bolt and Hi-Lok fasteners. The kit is an excellent stand alone ABDR Kit or DART Kit, but also can be used as an extension to your General Mechanic Tool Boxes in Phase, ISO and Depot Level Work. All tooling is supplied in a State of the Art System, including Router Cut Foam for Rapid inventory and Hardigg Transport Case with extra handles including telescoping transport handle, end casters, locking cable/hasps, purge of fill valves and forklift provisions or skid runners. Suitable for AVIM or AVUM LEVELS.

## Sheet Metal Preparation Kit

P/N: K-1000-2

NSN: 5180-01-584-5838

### Description

The FSI Sheet Metal Fastener Preparation Kit is equipped with everything necessary to prepare sheet metal applications for all typical and specialty fasteners up to 1/4" diameter, including Blind rivets & Blind Bolts, Solid AD fasteners, Jo-Bolt and Hi-Lok fasteners. The kit is an excellent stand alone ABDR Kit or DART Kit, but also can be used as an extension to your General Mechanic Tool Boxes in Phase, ISO and Depot Level Work. All tooling is supplied in a State of the Art System, including Router Cut Foam for Rapid inventory and Hardigg Transport Case with extra handles including telescoping transport handle, end casters, locking cable/hasps, purge of fill valves and forklift provisions or skid runners. Suitable for AVIM or AVUM LEVELS.



## Sheet Metal Installation Kit

P/N: K-1000-3

NSN: 5180-01-585-7544



### Description

The FSI Sheet Metal Fastener Installation Kit is equipped with all necessary tooling to install all fasteners up to 1/4" diameter, for Blind Rivets, Blind Bolts, Solid AD fasteners, Jo-Bolt and Hi-Lok fasteners. The kit is an excellent stand alone ABDR Kit or DART Kit, but also can be used as an extension to your General Mechanic Tool Boxes in Phase, ISO and Depot Level Work. All tooling is supplied in a State of the Art System including Router Cut Foam for Rapid inventory and Hardigg Transport Case with extra handles including telescoping transport handle, end casters, locking cable/hasps, purge of fill valves and forklift provisions or skid runners. Suitable for AVIM or AVUM LEVELS.

## K-1000 Roller Box

P/N: K-1000-HB

### Description

The K-1000-HB is a perfect addition to your hangar maintenance; allowing all three mobility boxes of your K-1000 to become a Facility Kit for use on a daily basis. This new Hangar Box measures 60" x 27-3/4" x 37-1/2" high, and has five (5) full width drawers partitioned to hold two (2) trays each. The drawers are configured to house the individual K-1000 trays to make the use of all tooling easily accessible during day to day maintenance. Individual drawers have their own lock-in/lock-out latch and a hinged bar, allowing all tools to be secured with a padlock. Each Hangar Box is equipped with two (2) fixed casters and two (2) swivel casters; each with 6" polyurethane wheels and tread-locks for easy positioning at a work station or an aircraft dock. It also has a push/pull bar attached, and is complete with a 60" x 30" x 1-3/4" (thick) hardwood top.



### Dimensions

Length	60" (152.4 cm)
Width	27.75" (70.5 cm)
Height	37.5" (95.3 cm)
Weight	620 lbs (281 kg) (Empty)

## Combination Blind Riveter Kit

**P/N: D-9000-MIL-1**  
**NSN: 5180-01-470-6538**



### Description

Ideal for Air Mobility and ABDR Support Applications, FSI's D-9000-MIL-1 provides hand hydraulic, air hydraulic and cordless blind riveters all in one convenient carrying case. Weighing less than 29 lbs., the D-9000-MIL-1 kit comes with the D-700 Hand Hydraulic Riveter with the Vari-Max feature added, the PT-100M Air Hydraulic Riveter and the PT-4000 Cordless Riveter.

The D-9000 Kits offer a wide selection of rivet nosepieces, which permits installation of virtually all-single action blind rivet thru 3/16" diameter currently in the DOD inventory. Although most often used to install CherryMax® (M7885/NAS9300), Huck-Clinch®, CherryLock® "A"/Olympic-Lok (NAS1400A) and Huck or Cherry Blind Bolts (MS90353/54 S or U), it is also capable of installing Huck SMLS (NAS1900S), Nutplate rivets (MIL-N-25027), Self-Plugging rivets (MS20600), POP® rivets (MIL-R-24243), Huck Magnlok (M7885/10) and Cherry Interlock wire draw rivets in 3/16" and 1/4" diameters commonly used on military and commercial vehicles; including the HMMWV, trucks, trailers, shelters, cargo containers, radar domes and ground support equipment.

### Contents

Qty	Description	P/N	Qty	Description	P/N
1	Hand Hydraulic Riveter	D-700C	1	1/4" Automotivce "T" Rivet Nosepiece	F155
1	Air Hydraulic Riveter	PT-100M	1	3/32" NAS1400A Nosepiece	F390
1	Cordless Riveter	PT-4000	1	1/8" NAS1400A Nosepiece	F391
1	Hand Mechanical Riveter	D-28	1	5/32" NAS1400A Nosepiece	F392
1	Battery Charger	F-4000A	1	3/16" NAS1400A Nosepiece	F393
2	Battery Pack Ni-MH (12V, 3.2Ah)	F-3001A	1	1/8" NAS1900S Nosepiece	F501
1	3/32" Nut-plate Nosepiece	F156	1	5/32" NAS1900S Nosepiece	F502
1	1/8" Nosepiece	F159	1	3/16" NAS1900S Nosepiece	F503
4	5/32"-3/16" Universal Nosepiece	F143	1	5/32" MS90353/54-S/U Nosepiece	F505U
1	1/4" Nosepiece	F142	1	3/16" MS90353/54-S/U Nosepiece	F506
1	3/16" Monobolt Nosepiece	F168	Pull-Up Studs & Anvils (UNC, UNF & Metric)		
1	1/4" Monobolt Nosepiece	F169			
1	3/16" MS Nosepiece	F580			
1	3/16" Bulb-tite Nosepiece	F396			
1	1/4" Bulb-tite Nosepiece	F398			





P/N: D-9000-MIL-2

NSN: 5180-01-470-6539

### Description

The D-9000-MIL-2 is ideal for field maintenance modification and BDR applications. It provides hand mechanical, hand hydraulic, air hydraulic and cordless blind riveters all in one convenient case. It can be used for Air Mobility, Line Maintenance and Battle Damage Repair Kits. The D-9000-Mil-2 installs all CherryMax® thru 1/4" and most Blind Bolts thru 3/16".

The D-9000-MIL-2 kit contains the pull-up studs and driving anvils used in conjunction with the hand hydraulic D-700C combination riveter-nutsetter, which permit installation of blind nuts (NAS1329/30, / MS 27130/31) in sizes 6-32 thru 3/8-16. The riveter provides over 4,000 lbs of pulling force and because of its unique two-stage valve system, wrist effort is reduced as the loads increase. For this reason, the D-700C riveter is equipped with a pressure regulating feature called Vari-Max which allows the user to set the pulling pressure desired for the particular lot of blind nuts being installed, thereby minimizing the chance of thread failure from excessive pulling force or improper installation due to inadequate upset loads.



### Contents

Qty	Description	P/N	Qty	Description	P/N
1	Hand Hydraulic Riveter	D-700C	1	1/8" NAS1400A Nosepiece	F391
1	Air Hydraulic Riveter	PT-100M	1	5/32" NAS1400A Nosepiece	F392
1	Cordless Riveter	PT-4000	1	3/16" NAS1400A Nosepiece	F393
1	Hand Mechanical Riveter	D-28	1	1/8" NAS1900S Nosepiece	F501
1	Battery Charger	F-4000A	1	5/32" NAS1900S Nosepiece	F502
2	Battery Pack Ni-MH (12V, 3.2Ah)	F-3001A	1	3/16" NAS1900S Nosepiece	F503
1	3/32" & 1/8" Nutplate Nosepiece	F156	1	5/32" MS90353/54-S/U Nosepiece	F505U
1	1/8" Nosepiece	F159	1	3/16" MS90353/54-S/U Nosepiece	F506
4	5/32" & 3/16" Nosepiece	F143		UNC Pull-up Studs & Anvils (10-24 to 3/8-16)	
1	1/4" Nosepiece	F142		UNF Pull-up Studs & Anvils (6-32 to 5/16-24)	
1	3/16" Monobolt Nosepiece	F168		Metric Pull-up Studs & Anvils (5mm to 10mm)	
1	1/4" Monobolt Nosepiece	F169	1	Extended Straight CherryMax® Head	F1074
1	3/16" MS Nosepiece	F580	1	90° CherryMax® Pulling Head	F1075
1	3/16" Bulb-tite Nosepiece	F396	1	Offset CherryMax® Pulling Head	F1076
1	1/4" Bulb-tite Nosepiece	F398			
1	1/4" Automotive "T" Rivet Nosepiece	F155			
1	3/32" NAS1400A Nosepiece	F390			

P/N: D-7421-MIL-1



## Description

## Kits

Weighing less than 5 lbs, the PT-7421 Air Operated Spin Pull to Pressure Nutsetter has evolved from the production tested reliable stroke adjustable version, the 7420. With pull force adjustment capability, the PT-7421 allows the user to insure that the force imparted to the fastener will not exceed the bearing strength of the material it is being installed into (ie. fiberglass, wood, composites) or the thread of the fastener itself. This feature significantly reduces the potential for damage or excessive wear to the pull up stud (mandrel) and anvil assembly due to material thickness variations. Affording a .275" stroke, the PT-7421 is capable of installing virtually all blind nut and inserts within its capacity range in one stroke, including Rivnuts® (NAS1329, NAS1330, MS27130), Plusnuts®, AVK ribbed inserts and Blind Nuts, Avdel Nutserts and Thin Sheet Nutserts® (TSN). Importantly, if the user inadvertently recycles the riveter after installation, the fastener threads and/or parent material remain unaffected. Utilizing standard Grade 8 Socket Head Cap Screws as pull up studs (mandrels) reduces replacement cost and permits wide flexibility for adapting to different fastener lengths. The driving anvil assembly is adjustable to permit quick adaption to most all standard blind rivet nuts or inserts.

## Contents

Qty	Description	P/N	Qty	Description	P/N	Qty	Description	P/N
1	Pull-to-Pressure Rivnut Tool	PT-7421	1	1/4 Anvil	F366	1	7421 Mandrel	F374-742
1	Hand Hydraulic Riveter	D-180	1	5/16 Anvil	F378	2	Washer	W-10
1	10-32 Pull-Up Stud	F362	2	Drive Nut	DN-10	1	Washer	W-1/4
1	10-24 Pull-Up Stud	F372	1	Drive Nut	DN-1/4	1	Washer	W-5/16
1	1/4-20 Pull-Up Stud	F373	1	Drive Nut	DN-5/16	1	Collet	F126-742
1	1/4-20 Pull-Up Stud	F373-S10	1	7421 Mandrel	F372-742	2	7421 Anvil	F365-742
1	5/16-18 Pull-Up Stud	F374	1	7421 Mandrel	F362-742	1	7421 Anvil	F366-742
1	5/16-18 Pull-Up Stud	F374-S5	6	7421 Mandrel	F373-742	1	7421 Anvil	F378-742
2	#10 Anvil	F365	6	7421 Mandrel	F3673-742S			



**Air Hydraulic Riveter Kit**

**P/N: PT-100-MIL-5**  
**NSN: 5130-01-373-6685**

**Description**

Evolving out of the successful D-100 series Hand Hydraulic version, the air operated PT-100 series Blind Riveter continues the tradition of offering a unique blend of power, versatility and compact size. Almost all straight pull style blind rivets with required installation loads of 4000 lbs. or less can be installed with the PT-100 series riveter. Although most often used to install CherryMax® and Huck-Clinch® blind rivets, a wide variety of adapters, nosepieces and special pulling heads are included in the PT-100-MIL-5 kit to insure maximum flexibility for any single action rivet requirement.



**Contents**

Qty	Description	P/N	Qty	Description	P/N
1	Air Hydraulic Riveter	PT-100	1	1/4" Monobolt Nosepiece	F169
1	Rotating Adapter Sleeve	F187-1AR	1	1/4" Automotive "T" Rivet Nosepiece	F155
1	Adapter Puller Shaft	F187-2A	1	Extended Straight CherryMax® Head	F1074
1	1/8" Nosepiece	F159	1	90° CherryMax® Pulling Head	F1075
1	5/32"- 3/16" CherryMax® Nosepiece	F143	1	Offset CherryMax® Pulling Head	F1076
1	1/4" Nosepiece	F142	1	Jaws, 3 Piece	F123
1	3/32" Nutplate Nosepiece	F156	1	Dynaswivel 1/4	F15-95460
1	3/16" Monobolt Nosepiece	F168	1	Metal Carrying Case	F606

**P/N: PT-100-1**  
**NSN: 5130-01-373-6684**



**Description**

Designed originally for the USAF ABDR Program, the PT-100-1 riveter permits the installation of all CherryMax® /Huck-Clinch® style rivets thru 1/4" diameter and comes with an adapter assembly for use with the right angle, offset and extended straight pulling heads. A special multi-plane air swivel fitting is also provided which helps minimize the hose whip interference in limited access areas.

## Kits

5

P/N: PT-100-WR/T  
NSN: 5180-01-557-4034



### Description

Reacting to the need for a versatile tool kit for aerospace and military aircraft maintenance and repair applications involving both wire draw style NAS1400A (Olympic-lok® and Cherrylock® "A") and bulbed, compressed column style M7885/NAS9300 (CherryMax®, HuckMax®, Allmax®) blind rivets, FSI is pleased to offer the PT-100-WR/T Blind Rivet Tool Kit.

Utilizing FSI's popular 4,000 lb pull force PT-100 air hydraulic riveter, the kit contains nosepieces and pulling heads to enable installation of all M7885 style rivets thru 1/4" diameter and all NAS1400A style rivets thru 3/16" diameter. In addition, the kit includes the adapter and the NAS1400A code blind rivet side ejection nose assemblies to enable access into restricted space areas while also affording the technician the ability to re-grip the rivets which may have longer stroke installation requirements. In addition to the two (2) piece jaw set furnished with the riveter, there is also a three (3) piece jaw set included in the spare parts canister. The three piece jaw set is normally used on all aluminum, serrated stemmed rivets for sizes 1/8" thru 3/16" diameter, however they may be used on most all single action rivet types thru 3/16" diameter.

### Contents

Qty	Description	P/N
1	Air Hydraulic Riveter	PT-100
1	1/8" CherryMax® Nosepiece	F159
1	5/32"-3/16" CherryMax® Nosepiece	F143
1	1/4" Nosepiece	F142
1	3/32" NAS1400A Nosepiece	F390
1	1/8" NAS1400A Nosepiece	F391
1	5/32" NAS1400A Nosepiece	F392
1	3/16" NAS1400A Nosepiece	F393
1	Adapter Puller Shaft	F687-2A

Qty	Description	P/N
1	MS Adapter Sleeve	F687-1A
1	Jaws, 3 Piece	F123
1	3/32" NAS1400A Pulling Head	F1060-3
1	1/8" NAS1400A Pulling Head	F1060-4
1	5/32" NAS1400A Pulling Head	F1060-5
1	3/16" NAS1400A Pulling Head	F1060-6
1	DYNASWIVEL 1/4"	F15-95460
1	Metal Carrying Case	F606-WR
1	Spare Parts Canister	F702

**SAFETY:** Read and follow all safety instructions  
**WARNING:** The safety guards are mandatory





**Cordless Riveter Kit**

**P/N: PT-3000-MIL-1**  
**NSN: 5130-01-373-9384**

**Description**

The PT-3000 is fast, efficient, ergonomically balanced and rivals the performance of air powered tools. It installs virtually all straight pull blind rivets including CherryMax® style (M7885) thru 3/16" diameter, and most 1/4" diameter all aluminum blind rivets.

The PT-3000-MIL-1 kit includes seven different nosepieces, an adapter assembly to permit use of the special right, offset, and extended straight CherryMax® pulling heads, a spare parts canister with extra jaws, jaw follower spring and jaw follower, two 12 volt DC battery packs, and a 120 volt AC/60 Hz battery charger.



**Contents**

Qty	Description	P/N	Qty	Description	P/N
1	Cordless Riveter	PT-3000	1	5/32" Nosepiece	F140
1	Charger	F-4000A	1	1/8" CherryMax® Nosepiece	F159
1	Battery Pack	F-3001A	1	3/32" Nutplate Nosepiece	F156
1	Rotating Adapter Sleeve	F187-1AR	1	5/32"-3/16" CherryMax® Nosepiece	F143
1	Adapter Puller Shaft	F187-3ACM	1	1/4" Nosepiece	F142
1	Adapter Sleeve Olympic-Lok®	F687-1A	1	3/16" Monobolt Nosepiece	F168
1	Adapter Puller Shaft Olympic-Lok®	F687-2A	1	3/16" MS20600 Nosepiece	F580
1	Jaws, 3 Piece	F123	1	Spare Part Canister	F702
1	Jaw Follower, 3/16MS , 1/4CM	F3245	1	Metal Carrying Case	F3602
1	Jaw Follwer Spring	F3093			

**P/N: PT-3000-MIL-2**



**Description**

The PT-3000-MIL-2 kit includes the PT-3000 riveter, seven different nosepieces (3/32" thru 1/4"), an adapter assembly to permit the use of the special right, offset, and extended straight CherryMax® pulling heads. Developing in excess of 1,900 lbs of pulling force, the PT-3000 is able to install virtually all straight pull blind rivets from 3/32" thru 3/16" diameter and even some all aluminum 1/4" diameters. This fast and efficient tool rivals any air powered performance.

**P/N: PT-4000-MIL-1**  
**NSN: 5130-01-449-9225**

**Description**

The PT-4000-MIL-1 provides nosepieces and adapters for installing all most popular 3/16" and 1/4" diameter blind rivets for both Aerospace and Industrial applications. Types of rivets installable with the PT-4000 include, but are not limited to, virtually all CherryMax® (M7885), Avdel or Cherry Monobolts®, and Pop® type rivets. The PT-4000 is also capable of installing both 5/32" and 3/16" Blind bolts (MS90353/54-S/U) with the proper nosepieces.



**Contents**

Qty	Description	P/N	Qty	Description	P/N
1	Cordless Riveter	PT-4000	1	3/16" Maxibolt Nosepiece	F506-MB
1	Charger	F-4000A	1	5/32" MS90353/54-S/U, BB Nosepiece	F505
2	Battery Pack	F-3001A	1	3/16" MS90353/54-S/U, BB Nosepiece	F506
1	Rotating Adapter Sleeve	F187-1AR	1	5/32" Jaw Set, Blind Bolts	F123-A
1	Adapter Puller Shaft	F187-3ACM	1	3/16" Jaw Set, Blind Bolts	F123-B
1	Adapter Sleeve Olympic-Lok®	F687-1A	1	Jaw Holder, Blind Bolts	F128
1	Adapter Puller Shaft Olympic-Lok®	F687-2A	1	Jaw Follower	F3245
1	3/16" CherryMax® Nosepiece	F143	1	Jaws, 3 Piece	F123
1	1/4" CherryMax® Nosepiece	F142	1	Spare Parts Canister	F702
1	1/4" Monobolt Nosepiece	F169	1	Metal Carrying Case	F3602
1	5/32" Maxibolt Nosepiece	F505-MB			

**P/N: PT-4000-MIL-2**



**Description**

The PT-4000-MIL-2 provides nosepieces and adapters for installing all most popular 3/16" and 1/4" diameter blind rivets for both Aerospace and Industrial applications. Types of rivets installable with the PT-4000 include, but are not limited to, virtually all CherryMax® (M7885), Avdel or Cherry Monobolts®, and Pop® type rivets. The PT-4000 is also capable of installing both 5/32" and 3/16" Blind bolts (MS90353/54-S/U) with the proper nosepieces. The kit includes special pulling heads; right angle, offset and extended straight for maximum blind riveting capability.

# Kits

## HAZLOC-CORDLESS MAKITA DRIVERS Class 1, Division 2 Rated Cordless Drivers



### Description

The Hazloc meets the NEC Article 513 Aircraft Hanger requirements for Class I Division 2 locations and is tested to Mil Standard 810F, Method 511.4. There is an indication lamp and beeper which has a precise sensor that indicates the following conditions with light and/or beeping: sufficient fastening, insufficient fastening, low battery power and battery too low to operate. The Hazloc has a torque accuracy of: +/- 10% or +/- sigma. The tool automatically shuts-off when pre-set fastening torque is reached to ensure accuracy.



### Models:

BFH040RAE	7 to 40 in lbs
BFH040FRAE	7 to 40 in lbs w/LED Light
BFH090RAE	30 to 80 in lbs
BFH090FRAE	30 to 80 in lbs w/LED Light
BFH120FRAE	44 to 106 in lbs w/LED Light



## Hand Hydraulic Riveter Kit

P/N: D-100-MIL-1

NSN: 5180-01-201-4978

### Description

Designed originally for military applications, the D-100-MIL series has become very popular with commercial airlines, private airplane, and helicopter fleet owners, as well as aerospace vehicle manufacturers' field modification and repair teams. The versatility of the D-180, with its wide capability and compact size, may be utilized to install a variety of blind fasteners.

Relying on the D-180 (military version) riveter, this kit provides the ability to install CherryMax® rivets (1/8"-1/4"), Pull-thru Nutplate rivets (3/32" thru 1/8") and all POP type rivets from 3/32" thru 1/4" diameter. In addition, pull-up studs and driving anvils are provided for Rivnut® sizes 6-32, 8-32, 10-32, 1/4-28, 10-24, 1/4-20, 5/16-18 and 3/8. This kit does not include the special CherryMax pulling heads.



### Contents

Qty	Description	P/N	Qty	Description	P/N
1	Hand Hydraulic Riveter	D-180	1	5/16 Driving Anvil	F378
1	Adapter Sleeve	F187-1AF	1	3/8 Driving Anvil	F379
1	Adapter Puller Shaft	F187-2A	1	6-32 Pull-up Stud	F1
1	3/32" Nutplate Rivet Nosepiece	F156	1	8-32 Pull-Up Stud	F2
1	1/8" Nosepiece	F159	1	10-32 Pull-Up Stud	F3
1	5/32"-3/16" CherryMax® Nosepiece	F143	1	1/4-28 Pull-Up Stud	F4
1	1/4" Nosepiece	F142	1	10-24 Pull-Up Stud	F5
1	#6 Driving Anvil	F367	1	1/4-20 Pull-Up Stud	F6
1	#8 Driving Anvil	F364	1	5/16-18 Pull-Up Stud	F7
1	#10 Driving Anvil	F365	1	3/8-16 Pull-Up Stud	F8
1	1/4 Driving Anvil	F366	1	Master Shaft	F170-A
1	#10 TSN Driving Anvil	F176	1	Turn Nut	F171
1	1/4 TSN Driving Anvil	F177	1	Metal Carrying Case	F601



# Kits

P/N: D-100-MIL-2  
 NSN: 5180-01-201-4979



## Description

Relying on the D-180 (military version) riveter, this kit provides the ability to install CherryMax rivets (1/8"-1/4"), Pull-thru Nutplate rivets (3/32"-1/8") and all Pop type rivets from 3/32" thru 1/4" diameter. In addition pull-up studs and driving anvils are provided for Rivnut® sizes 6-32, 8-32, 10-32, 1/4-28, 10-24, 1/4-20, 5/16-18 and 3/8-16 (up to three rad). An adapter is included to permit the tool to be used with the Right Angle, Offset and Extended Straight pulling heads for CherryMax® and Huck-Clinch® blind rivets, which are found in the D-100-MIL-2 kit.

## Contents

Qty	Description	P/N	Qty	Description	P/N
1	Hand Hydraulic Riveter	D-180	1	5/16 Driving Anvil	F378
1	Adapter Sleeve	F187-1AF	1	3/8 Driving Anvil	F379
1	Adapter Puller Shaft	F187-2A	1	6-32 Pull-Up Stud	F1 (F360)
1	3/32 Nutplate Nosepiece	F156	1	8-32 Pull-Up Stud	F2 (F361)
1	1/8" Nosepiece	F159	1	10-32 Pull-Up Stud	F3 (F362)
1	5/32"-3/16" CherryMax® Nosepiece	F143	1	1/4-28 Pull-Up Stud	F4 (F363)
1	1/4" Nosepiece	F142	1	10-24 Pull-Up Stud	F5 (F372)
1	#6 Driving Anvil	F367	1	1/4-20 Pull-Up Stud	F6 (F373)
1	#8 Driving Anvil	F364	1	5/16-18 Pull-Up Stud	F7 (F374)
1	#10 Driving Anvil	F365	1	3/8-16 Pull-Up Stud	F8 (F375)
1	1/4 Driving Anvil	F366	1	Master Shaft	F170-A
1	#10 TSN Driving Anvil	F176	1	Turn Nut	F171
1	1/4 TSN Driving Anvil	F177	1	Metal Carrying Case	F601
1	Extended Straight CherryMax® Head	F1074	1	Offset CherryMax® Pulling Head	F1076
1	90° CherryMax® Pulling Head	F1075			



**P/N: D-100-N**

**Description**

The D-100-C Hand Hydraulic Nutsetter provides up to 3750 lbs of pulling force over a .625" stroke. In the event there is limited access where the larger air operated tool does not fit, the sheet metal technician has the capacity to perform needed installation. Provided in the nutsetting configuration, the D-100 can be supplied with different thread sizes and pull-up stud lengths required for Metric, as well as other UNC and UNF threads.



**Contents**

Qty	Description	P/N	Qty	Description	P/N
1	Hand Hydraulic Riveter	D-100-C	1	1/4-28 Pull-Up Stud	F363-C
1	Master Shaft	F170-A	1	#8 Driving Anvil	F364-C
1	Turn Nut	F171	1	#10 Driving Anvil	F365-C
1	6-32 Pull-Up Stud	F360-C	1	1/4 Driving Anvil	F366-C
1	8-32 Pull-Up Stud	F361-C	1	#6 Driving Anvil	F367-C
1	10-32 Pull-Up Stud	F362-C	1	Plastic Case	F197

**P/N: D-100-RN**



**Description**

The D-100-C Hand Hydraulic Nutsetter supplied in the kit provides up to 3,750 lbs of pulling force over a .625" stroke. In the event there are limited access areas where the larger air operated tool will not fit, or if compressed air is unavailable, the sheet metal technician has the capability to perform needed installation.

The D-100 series riveters in the FSI kits are currently being used by commercial airlines, aerospace vehicle manufacturers, military aviation maintenance organizations, general aviation fixed based operators, private aircraft fleets and aircraft kit homebuilders.

**Contents**

Qty	Description	P/N	Qty	Description	P/N
1	Hand Hydraulic Riveter	D-100-C	1	#6 Driving Anvil	F367-C
1	Master Shaft	F170-A	1	#8 Driving Anvil	F364-C
1	Turn Nut	F171	1	#10 Driving Anvil	F365-C
1	6-32 Pull-Up Stud	F360-C	1	1/4 Driving Anvil	F366-C
1	8-32 Pull-Up Stud	F361-C	1	3/32" Nosepiece	F156-C
1	10-32 Pull-Up Stud	F362-C	1	1/8" Nosepiece	F159-C
1	1/4-28 Pull-Up Stud	F363-C	1	1/4" Nosepiece	F142-C
1	5/32"-3/16" Nosepiece	F143-C	1	Plastic Case	F197

# Kits

P/N: D-700-MIL-2  
 NSN: 5180-01-430-5361



## Description

This kit features the special CherryMax® right angle, offset and extended straight pulling heads for all sizes thru 3/16" OS diameter. In addition, the D-700C can be easily adapted to install wire draw rivets thru 3/16" diameter including CherryMax® "A", InterMax®, Avdel MBC, Cherrylock® "A" Code, and Cherry Interlock® blind rivets. The D-700C riveter also comes with the Vari-Max™ adjustable pressure control to permit setting of pulling force when installing blind threaded fasteners.

## Contents

Qty	Description	P/N	Qty	Description	P/N	Qty	Description	P/N
1	Hand Hydraulic Riveter	D-700-C	1	10-24 Pull-Up Stud	F372	1	1/4 TSN Driving Anvil	F177
1	3/32" Nutplate Nosepiece	F156	1	1/4-20 Pull-Up Stud	F373	1	Master Shaft	F170-A
1	5/32"-3/16" Nosepiece	F143	1	5/16-18 Pull-Up Stud	F374	1	Turn Nut	F171
1	1/4" Nosepiece	F142	1	3/8-16 Pull-Up Stud	F375	1	Rotating Adapter	F187-AR
1	1/8" Nosepiece	F159	1	6mm Pull-Up Stud	F380	1	Extended Straight Cherry® Head	F1074
1	5/32" Blind Bolt Nosepiece	F505U	1	#6 Driving Anvil	F367	1	90° CherryMax® Pulling Head	F1075
1	3/16" Blind Bolt Nosepiece	F506	1	#8 Driving Anvil	F364	1	Offset CherryMax® Pulling Head	F1076
1	6-32 Pull-Up Stud	F360	1	#10 Driving Anvil	F365	1	5/32" Jaws, Blind Bolt	F123-A
1	8-32 Pull-Up Stud	F361	2	1/4 Driving Anvil	F366	1	3/16" Jaws, Blind Bolt	F123-B
1	10-32 Pull-Up Stud	F362	2	5/16 Driving Anvil	F378	1	Jaw Holder, Blind Bolts	F128
1	1/4-28 Pull-Up Stud	F363	1	3/8 Driving Anvil	F379	1	Jaw Follower, Blind Bolt, D-700C	F758
1	5/16-24 Pull-Up Stud	F377	1	#10 TSN Driving Anvil	F176	1	Metal Carrying Case	F702



**P/N: D-700-N**  
**NSN: 5120-01-430-5325**

### Description

The D-700C Nutsetter provides up to 5,000 lbs of pulling force and more than 3/4" stroke. This Nutsetter is capable of installing Rivnuts®, Plusnuts®, Blind Nuts, Avdel Nutserts and Thin Sheet Nutserts; plus any other threaded fastener. It comes with the Vari-Max™ adjustable pressure control to permit precise setting of pulling force when installing blind threaded fasteners. A two stage valve permits a greatly reduced wrist effort for installation of the wide variety of fastener applications.



### Contents

Qty	Description	P/N	Qty	Description	P/N
1	Hand Hydraulic Riveter	D-700-VM	1	6mm Pull-Up Stud	F380
1	Master Shaft	F170-A	1	#6 Driving Anvil	F367
1	Turn Nut	F171	1	#8 Driving Anvil	F364
1	6-32 Pull-Up Stud	F360	1	#10 Driving Anvil	F365
1	8-32 Pull-Up Stud	F361	2	1/4 Driving Anvil	F366
1	10-32 Pull-Up Stud	F362	2	5/16 Driving Anvil	F378
1	1/4-28 Pull-Up Stud	F363	1	3/8 Driving Anvil	F379
1	5/16-24 Pull-Up Stud	F377	1	#10 TSN Driving Anvil	F176
1	10-24 Pull-Up Stud	F372	1	1/4 TSN Driving Anvil	F177
1	1/4-20 Pull-Up Stud	F373	2	Spare Parts Canister	F702
1	5/16-18 Pull-Up Stud	F374	1	Plastic Case	F797
1	3/8-16 Pull-Up Stud	F375			



# Accessories

## Rotating Adapters 360°



### Description

Available for use with all FSI Cordless, Air Hydraulic and Hand Hydraulic Blind Riveters and Lockbolt tools, these adapters permit the artisan to position the special right angle and offset pulling heads through a complete 360 degree angle of rotation in either clockwise or counterclockwise direction.

Adapter Types	P/N
Huck Offset Pulling Heads	F4187-AR
CherryMax® Pulling Heads	F187-AR
Olympic-Lok Pulling Heads	F687-AR

## Close Edge Distance Pulling Heads



### Description

Reacting to the airframe sheet metal artisans' need for improved close edge distance (CED) nose assemblies for single action blind rivets, blind bolts, and lockbolts, FSI is pleased to offer the F4000 Series CED Nose Assemblies. Fitting conveniently onto the most popular aerospace quality air-hydraulic and cordless riveters, the F4000 Series CED Nose Assemblies are available in a 1.5" and 3.0" configurations eliminating the need in many cases to utilize much more expensive offset pulling head assemblies. The F4000 Series CED Nose Assemblies are available in all sizes from 3/32" diameter thru 1/4" diameter for most all single action, straight pull aerospace blind rivets and blind bolts, as well as 5/32" and 3/16" diameter lockbolts. The CED nose assemblies offer maximum capability for minimum edge distance applications where a straight nose assembly may be utilized.

## Hand Riveter for Plastic Rivets



P/N: D-75

### Description

This unique, patented tool sets plastic rivets in one stroke. The in-line design allows access where conventional right-angle tools cannot reach. Plastic rivets have been used by automobile manufacturers for years and offer significant benefits over metal rivets.

## Nosepieces - D-9000 Bar

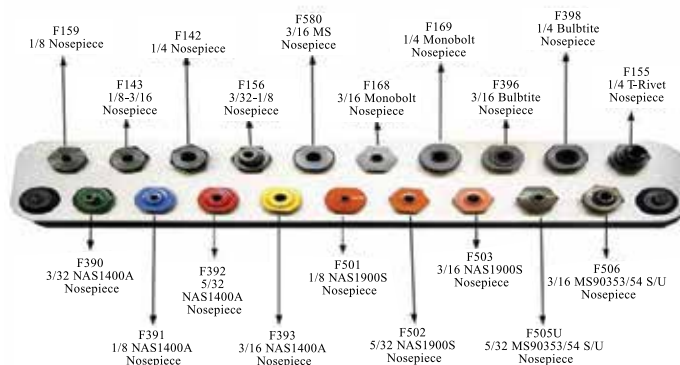

## Rivnut Studs & Anvils



**SAFETY:** Read and follow all safety instructions  
**WARNING:** The safety guards are mandatory

# Light String Sets 6



## Contents

Light String Sets



# Innovative Lighting Solutions



## Light String Features

1. Tailor Made with Electrical Drops
2. Weathertight, Single Continuous Strand
3. FOD Safety Features, Plastic Light Covers
4. Economical, Single Cord into the Aircraft
5. Reliable, 110 volt, 15 Amp
6. Long Lasting, Florescent Teflon Coated Bulbs











**K-1000-H**

**SHEET METAL MAINTAINERS TOOL BOX**



**CORPORATE HEADQUARTERS  
SONOMA, CALIFORNIA, USA**



**LIMITED WARRANTY STATEMENT**

Fastening Systems International ("FSI") warrants that its products are free from defects in material and/or workmanship for a period of one year from the original date of purchase from FSI or an FSI authorized dealer. This warranty does not apply to products that (i) exhibit wear and tear from ordinary use; (ii) have been misapplied, misused, or operated outside of its intended use; (iii) have been modified or repaired without consent of FSI, neglected, or improperly maintained; and (iv) were damaged by accident, fire, or other Act of God.

TO THE EXTENT ALLOWED BY LOCAL LAW, NEITHER FSI NOR ITS THIRD PARTY SUPPLIERS MAKES ANY OTHER WARRANTY OR CONDITION OF ANY KIND, WHETHER EXPRESS OR IMPLIED WARRANTIES OR CONDITIONS OF MERCHANTABILITY, SATISFACTORY QUALITY, AND FITNESS FOR A PARTICULAR PURPOSE

Any notice of defect shall be made in writing to :

Fastening Systems International, Inc., 1206 East MacArthur Street, Sonoma, CA 95476, Attn: Customer Service

If FSI receives, in writing and during the applicable warranty period, any notice of defect covered by FSI's warranty, FSI shall either repair or replace the product, at FSI's election. If FSI is unable to repair or replace a defective product covered by FSI's warranty, FSI shall refund the purchase price of the product. Repair or replacement and refund of the purchase price shall be the sole and exclusive remedy. TO THE EXTENT ALLOWED BY LOCAL LAW, EXCEPT FOR THE OBLIGATIONS SPECIFICALLY SET FORTH IN THIS WARRANTY STATEMENT, IN NO EVENT SHALL FSI OR ITS THIRD PARTY SUPPLIERS BE LIABLE FOR DIRECT, INDIRECT, SPECIAL, INCIDENTAL OR CONSEQUENTIAL DAMAGES, WHETHER BASED ON CONTRACT, TORT, OR ANY OTHER LEGAL THEORY AND WHETHER ADVISED OF THE POSSIBILITY OF SUCH DAMAGES. FSI continually strives to improve its products which may result in specifications being changed after publication of this catalog.

**Fastening Systems**

**International, Inc**

[www.fsirivet.com](http://www.fsirivet.com)

1206 E. MacArthur Street  
Sonoma, CA 95476 USA

Tel: 707-935-1170 Fax: 707-935-1828

[sales@fsirivet.com](mailto:sales@fsirivet.com)

