

H746 Series Pulling Head

For Standard MBC Blind Rivets with Cherry® Tooling

H746-4MBC Pulling Head installs 1/8" Standard MBC H746-5MBC Pulling Head installs 5/32" Standard MBC H746-6MBC Pulling Head installs 3/16" Standard MBC (each pulling head is sold separately)



CHERRY®
AEROSPACE

1224 East Warner Ave,
Santa Ana, Ca 92705
Tel: 1-714-545-5511
www.cherryaerospace.com

PREVENTATIVE MAINTENANCE

- Clean the Nosepiece, Jaw Cavity and inspect Jaws and Spring every 500 installations or whenever a failure occurs; replace Spring and Jaws if worn.
- Lubricate outside configuration of the Jaws with Lubriplate® or similar light grease.
- Inspect regularly and keep active area clean and in good working condition.
- Replace worn or broken components.
When re-assembling align the jaws with the jaw follower as shown in the exploded view (items 3 and 4); use Loctite® 242 on threaded components.

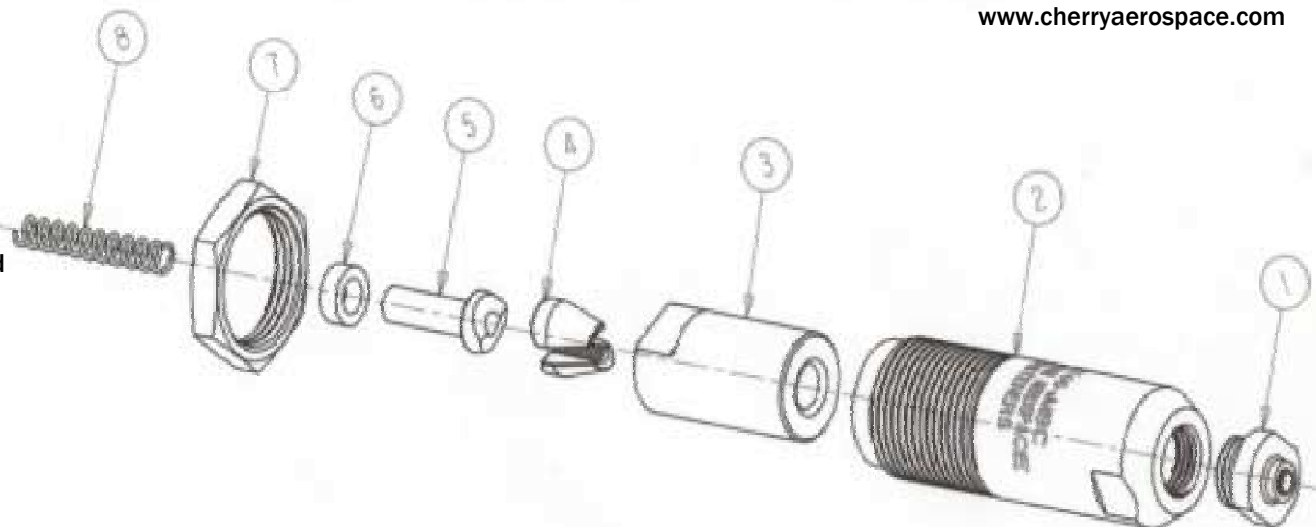

PARTS LIST

PULLING HEAD ASSY NO.	NOSEPIECE	SLEEVE	COLLET	JAWS	JAW FOLLOWER	BUMPER	NUT	SPRING
ITEM NO	1	2	3	4	5	6	7	8
H746-4MBC	845-027	845-031-4	701B29 A	701B18	753A14A	701A33	671A16	P1155
H746-5MBC	845-028	845-031-5	701B29 A	701B18	753A14A	701A33	671A16	P1155
H746-6MBC	845-029	845-031-6	701B29 A	701B18	753A14A	701A33	671A16	P1155

WARRANTY

Seller warrants the goods conform to applicable specifications and drawings and will be manufactured and inspected according to generally accepted practices of companies manufacturing industrial or aerospace fasteners. In the event of any breach of the foregoing warranty, Buyer's sole remedy shall be to return defective goods (after receiving authorization from Seller) for replacement or refund of the purchase price, at the Seller's option. Seller agrees to any freight costs in connection with the return of any defective goods, but any costs relating to removal of the defective or nonconforming goods or installation of replacement goods shall be Buyer's responsibility. SELLER'S WARRANTY DOES NOT APPLY WHEN ANY PHYSICAL OR CHEMICAL CHANGE IN THE FORM OF THE PRODUCT IS MADE BY BUYER. THE FOREGOING EXPRESS WARRANTY AND REMEDY ARE EXCLUSIVE AND ARE IN LIEU OF ALL OTHER WARRANTIES AND REMEDIES; ANY IMPLIED WARRANTY AS TO QUALITY, FITNESS FOR PURPOSE, OR MERCHANTABILITY IS HEREBY SPECIFICALLY DISCLAIMED AND EXCLUDED BY SELLER. This warranty is void if seller is not notified in writing of any rejection of the goods within ninety (90) days after receipt of the goods by buyer. Seller shall not be liable under any circumstances for incidental, special or consequential damages arising in whole or in part from any breach by Seller, AND SUCH INCIDENTAL, SPECIAL, OR CONSEQUENTIAL DAMAGES ARE HEREBY EXPRESSLY EXCLUDED. Our policy is one of continuous development. Specifications shown in this document may be subject to changes introduced after publication. NOTE: The properties, strength, dimensions, installed characteristics and all other information in these materials are for guidance only to aid in the correct selection of the products described herein and is not intended or implied as part of the above warranty. All applications should be evaluated for functional stability and available samples of the described parts can be requested for installed tests, suitability and evaluations.

Loctite® 630-A is a registered trademark of Henkel Corporation
Lubriplate® is a registered trademark of Fiske Brothers Refining Co.

For more information please contact our Technical Services Department at tel. 714-850-6022